

MODULO QUADRO

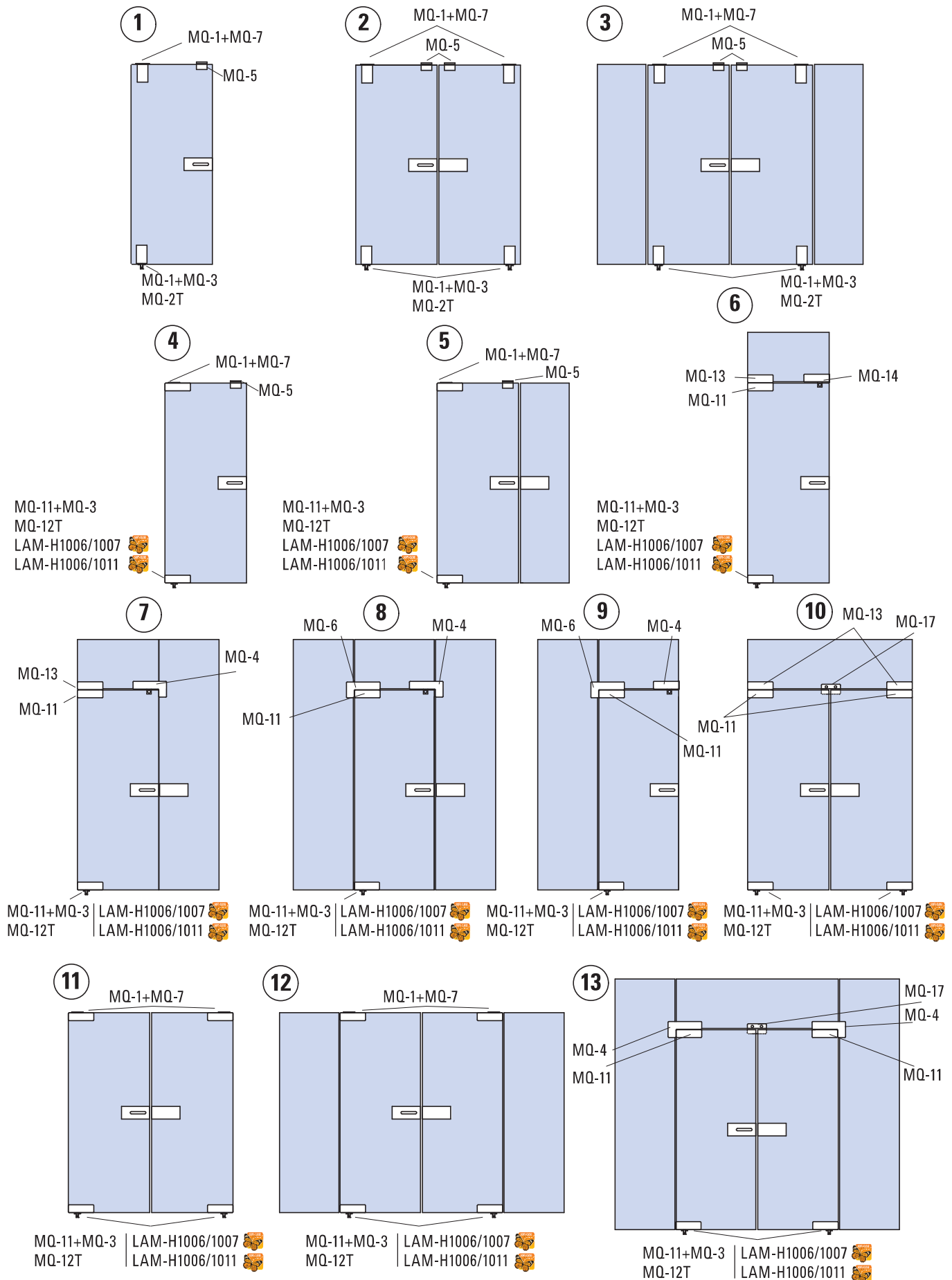

TIPOLOGIA DI APPLICAZIONE / APPLICATION TYPOLOGIES / KOMPOSITIONSMÖGLICHKEITEN DES SYSTEM



MQ-1

- Cerniera inferiore/superiore.
 - Top/bottom patch.
 - Oberes/Unteres Pendeltürband.
- CR - NS

€► G.21

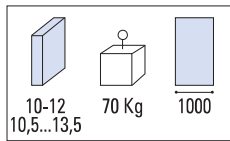
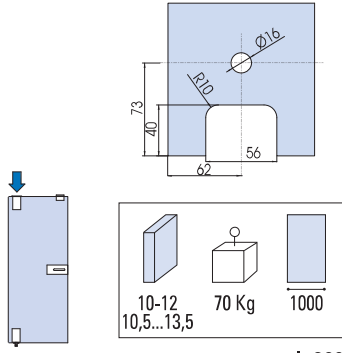
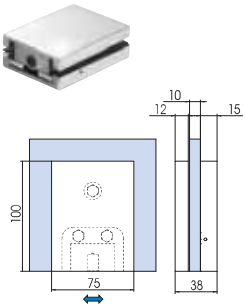

xla269



MQ2-1

- Cerniera inferiore per pompa Italia.
 - Bottom pivot hinge for square closer.
 - Unteres Pendeltürband für Bodentürschließer mit Vierkant.
- CR - NS

€► G.22

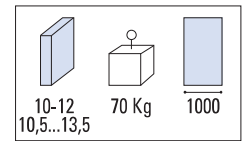
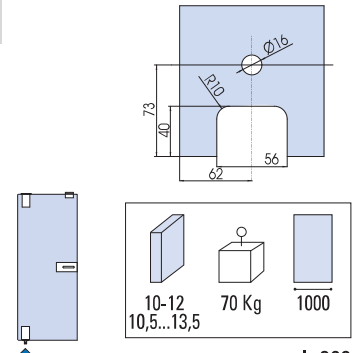
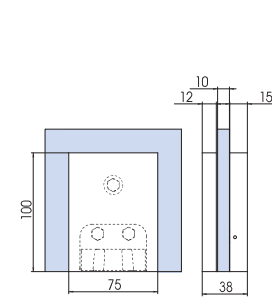

xla269



MQ-2-T

- Cerniera inferiore per pompa Tedesca.
 - Bottom pivot hinge for german closer.
 - Unteres Pendeltürband für Bodentürschließer mit flachkonischer Achse.
- CR - NS

€► G.23

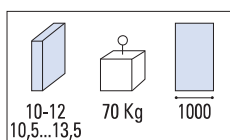
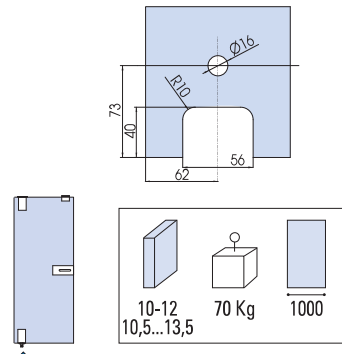
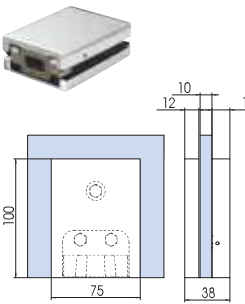

xla269



MQ-11

- Cerniera inferiore/superiore registrabile.
 - Top/Bottom patch with regulation.
 - Oberer/Unterer Eckbeschlag mit verstellbarem Lager.
- CR - NS

€► G.24

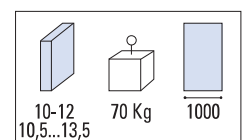
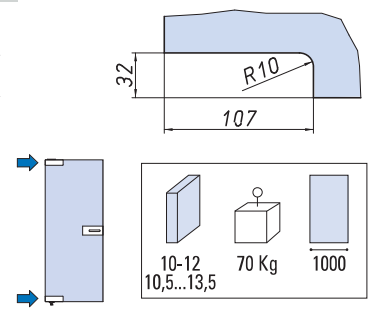
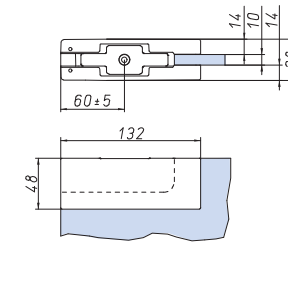

xla268a



MQ-12-I

- Cerniera inferiore per pompa Italia.
 - Bottom pivot hinge for square closer.
 - Unteres Pendeltürband für Bodentürschließer mit Vierkant.
- CR - NS

€► G.26

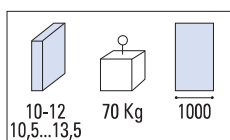
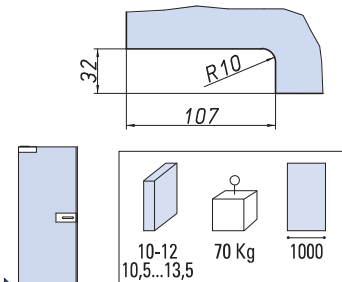
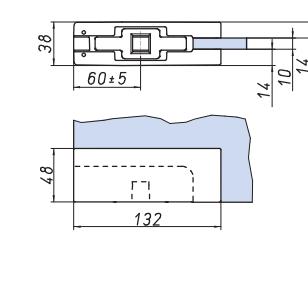

xme268a



MQ-12-T

- Cerniera inferiore per pompa Tedesca.
 - Bottom pivot hinge for german closer.
 - Unteres Pendeltürband für Bodentürschließer mit flachkonischer Achse.
- CR - NS

€► G.25

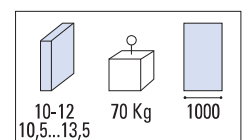
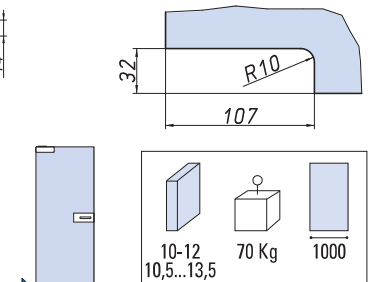
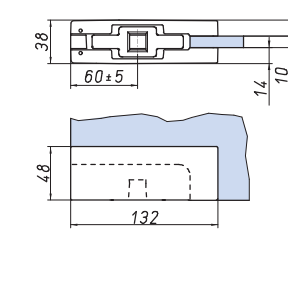

xla268a

MQ-13

€► G.27

- Cerniera con attacco sopra luce/muro perno mm 10.
 - Overpanel patch with pivot 10 mm and wall plate.
 - Oberlichtbeschlag mit Zapfen 10 mm. und Befestigungslasche
- CR - NS

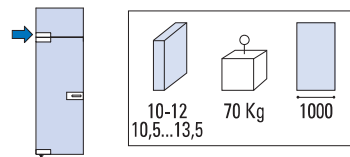
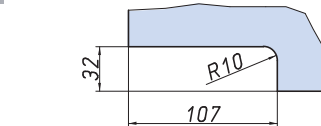
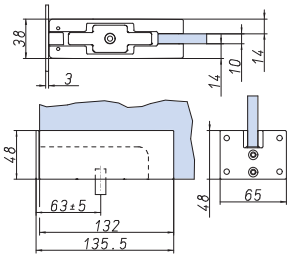

xla268a-1

MQ-6

€► G.28

- Cerniera con attacco sopra luce vetro fisso perno mm 10.
 - Patch for overpanel and side panel with pivot 10 mm.
 - Winkeloberlichtbeschlag mit Zapfen mm 10.
- CR - NS

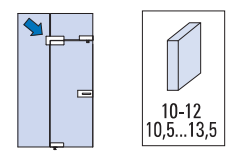
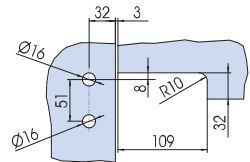
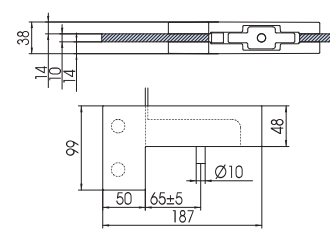

xla268c

MQ-4

€► G.29

- Cerniera con attacco sopra luce vetro fisso con battuta.
 - Patch for overpanel and side panel with stop.
 - Winkeloberlichtbeschlag mit Anschlag.
- CR - NS

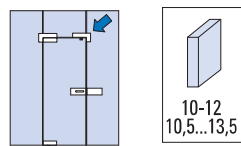
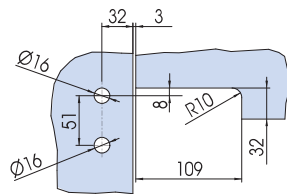
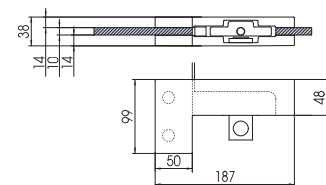

xla268c-1

MQ-8

€► G.30

- Cerniera con attacco sopra luce vetro fisso con inserto cieco.
 - Patch for overpanel and side panel with blind insert.
 - Winkeloberlichtbeschlag mit Blindeinsatz.
- CR - NS

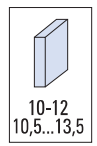
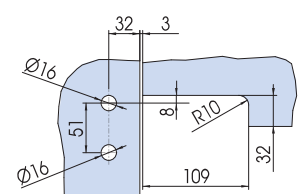
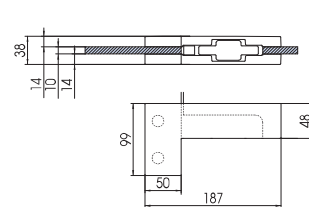

xla268c-1

MQ-14

€► G.31

- Cerniera sopra luce/muro con battuta.
 - Overpanel patch with stop and wall plate.
 - Oberlichtbeschlag mit Anschlag und Befestigungslasche.
- CR - NS

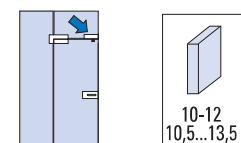
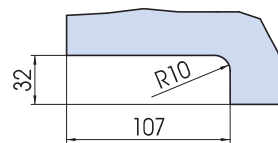
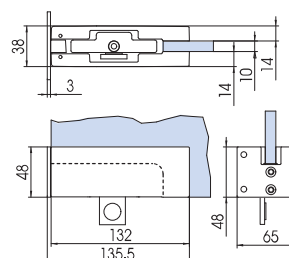

xla268b-1

MQ-16

€► G.32

- Cerniera regolabile con attacco a sopra luce e fisso laterale.
 - For overpanel and side panel.
 - Winkeloberlichtbeschlag.
- CR - NS

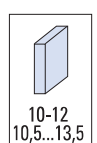
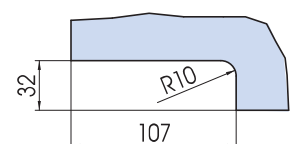
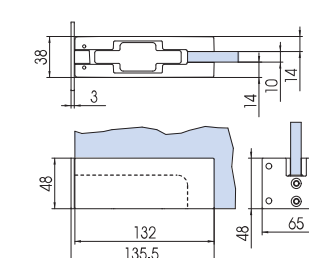

xla268b



MQ-5

€ ▶ G.34

- Battuta per porta singola.
- Single-stop with ceiling installation.
- Anschlag für Deckenbefestigung 1-flg. CR - NS

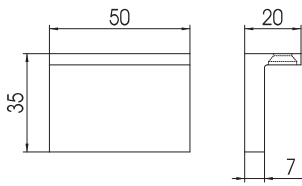

xla268d



MQ-3

€ ▶ G.33

- Pozzetto inferiore con perno regolabile per MQ-1, MQ-11.
- Floor installation bottom pivot ball-bearing for MQ-1, MQ-11.
- Bodenbuchse Kugelgelagert für MQ-1, MQ-11. NS

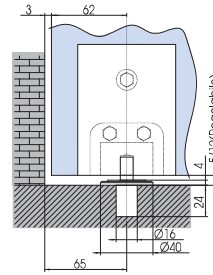

xla268d



MQ-7

€ ▶ G.35

- Perno superiore rettangolare.
- Rectangular top pin.
- Oberer zapfen eckig.

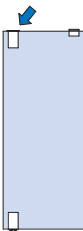
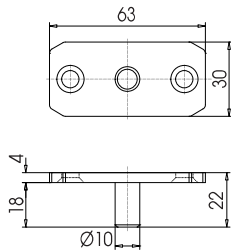

xla268d



MQ-10

€ ▶ G.39

- Battuta per porta doppia.
- Double stop with ceiling installation.
- Doppelteranschlag für Deckenbefestigung 2-flg. CR - NS

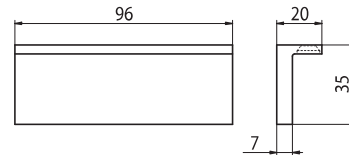

xla232



MQ-9

€ ▶ G.37

- Supporto vetro fisso.
- Wall connector.
- Wandhalter. CR - NS

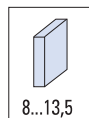
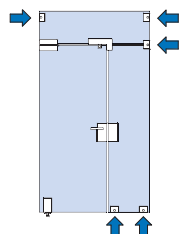
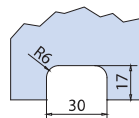

xme292-1



MQ-15

€ ▶ G.38

- Morsetto per aggancio due vetri.
- Connector.
- Verbindungsbeschlag. CR - NS

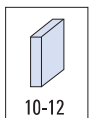
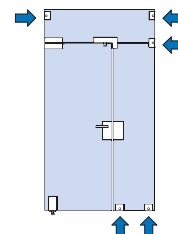
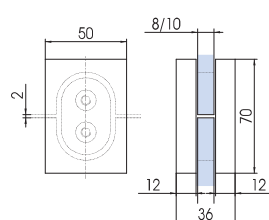
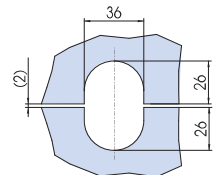

xla268e

MQ-17

€ ▶ G.40

- Battuta per porta doppia con attacco a sopra luce.
- Double stop fixed on overpanel.
- Doppelanschlag am Oberlicht. CR - NS

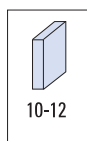
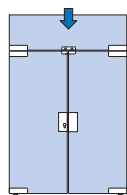
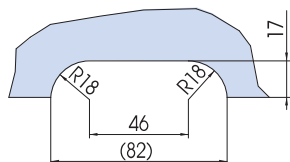
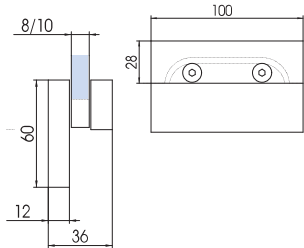

10-12

xla268e

XT-83 B

€ ▶ G.41

- Perno a pavimento con quadro tedesco ovale.
- Floor pivot with German profile spindle.
- Bodenbuchse mit flachkonischer Achse.

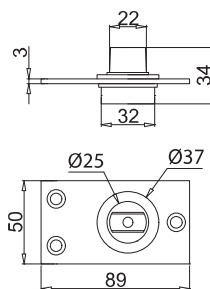

gpe012