

B-5040-SI KAMPIONA DRAIN

SCARICO INFERIORE / LOWER DRAIN / UNTERER ABFLUSS

e▶ H.279 → e▶ H.285

NEW **NO** design Patent Pending

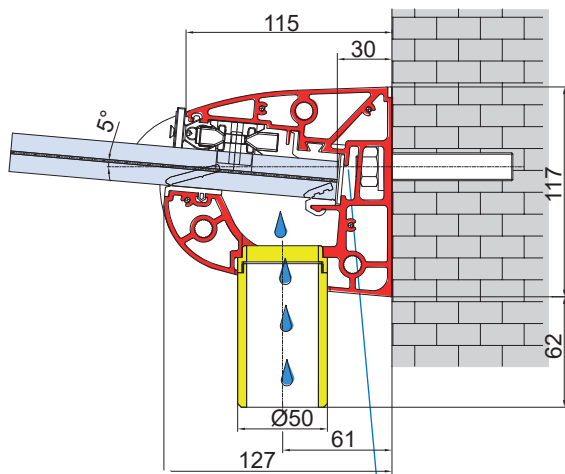

Griglia antifoglie
Anti-leaf mesh
Laubschutznetz

Smusso per deflusso acqua
Contouring indent for water passage
Konturbearbeitung für Wasserdurchlauf

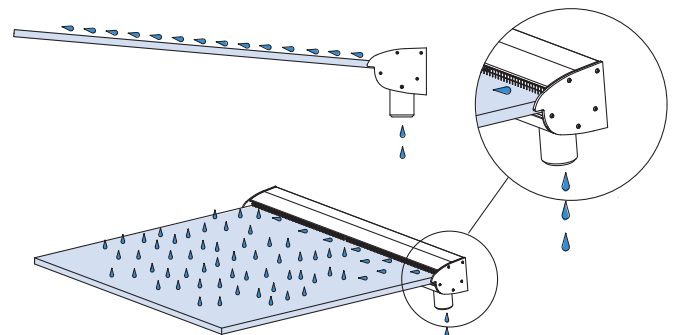
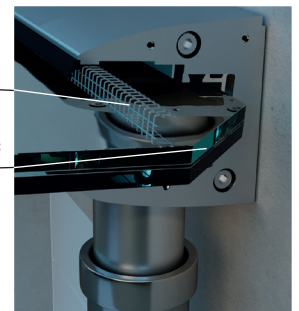

- Sede per LED 18x5 max, per illuminazione vetro
- Channel for LED, for glass lighting
- Sitz für LED, für Beleuchtung des Glas

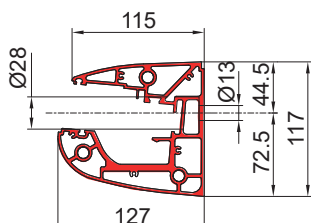

Quota variabile / Variable size / Variables Maß

100 MAX 100 200 200 200 200 200 200 100 MAX

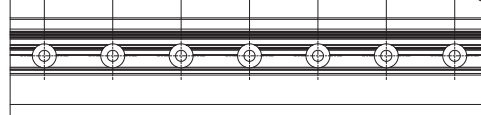

- Foratura per scarico inferiore
- Hole for low drain
- Bohrung für unteren Abfluss

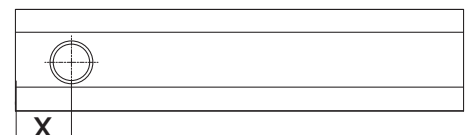

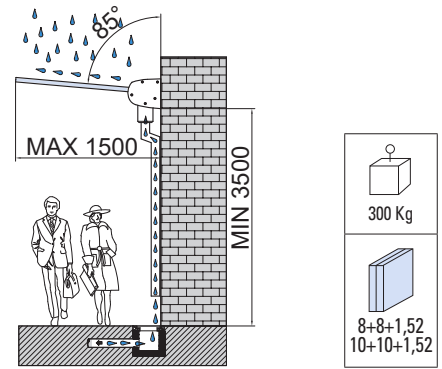

SET (TAPPI LATERALI E SCARICHI ACQUA ESCLUSI)

SET (ENDCAPS AND DRAIN NOT INCLUDED)

SET (ENDKAPPEN UND ABFLUSS NICHT ENTHALTEN)

B-5040 set 1

L=1500 mm
con/with/mit
3 Jolly Pack

N. 3 pcs

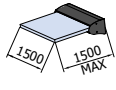

B-5040 set 2

L=2000 mm
con/with/mit
4 Jolly Pack

N. 4 pcs

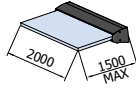

B-5040set 3

L=3000 mm
con/with/mit
6 Jolly Pack

N. 6 pcs

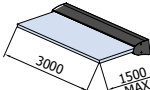

B-5040 set 4

L=4000 mm
con/with/mit
8 Jolly Pack

N. 8 pcs

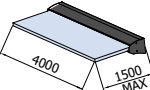

B-5040 set 6

L=6000 mm
con/with/mit
12 Jolly Pack

12 pcs

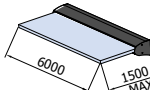

B-5040 set MIS

- Tagliato a misura cliente
- Custom length
- Nach Mass geschnitten

N. 2-8 pcs

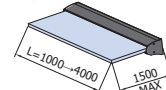

- Lavorazione vetro. Solo la lastra superiore è forata.
- Glass preparation. Only the upper glass panel is drilled.
- Glasbearbeitung. Nur die obere Scheibe wird gebohrt.

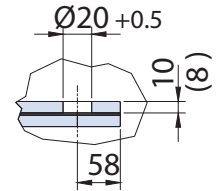

- Lavorazione vetro alternativa.
- Alternative glass preparation.
- Alternative Glasbearbeitung.

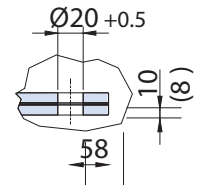

SET B-5040 CON SCARICO INFERIORE B-5040-SI

SET B-5040 WITH LATERAL DRAIN B-5040-SI

SET B-5040 MIT SEITLICHER ABFLUSS B-5040-SI

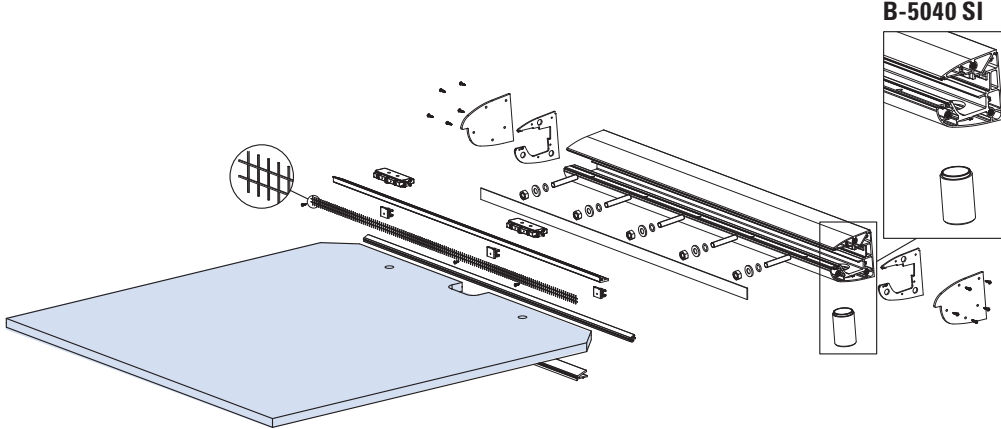

B-5040 SI

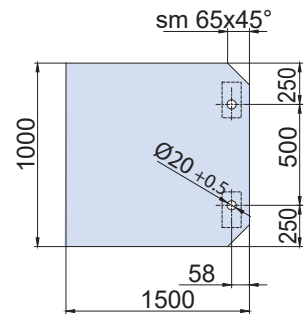
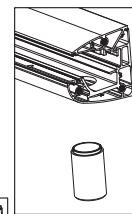

LAV-5040-SI

- Foratura scarico inferiore fatta su profilo intero a C.N.C.
- Tubo di scarico e tappi esclusi.
- Holes for low drain created on entire profile via C.N.C.
- Drain pipe and endcaps not included.
- Bohrung für unteren Abfluss am CNC-gefrästen Innenprofil.
- Abflussrohr und Endkappen nicht enthalten.

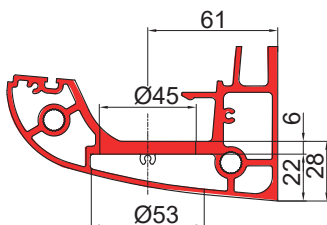
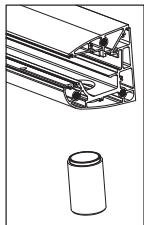

B-5040 SI

- Tappi ciechi con guarnizioni e scarico acqua inferiore.
- Blind encaps with gaskets and lower drain pipe.
- Geschlossen Endkappen mit Dichtungen und unteres Abflussrohr.

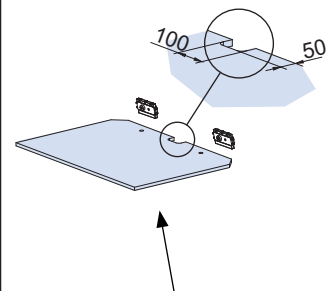
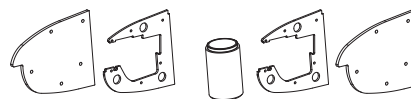

- Tasca opzionale per flusso acqua
- Optional cavity for water flow
- Optionale Tasche für Wasserfluss

xme558b

PENSILINA KAMPIONA DRAIN

DATI TECNICI / TECHNICAL DATA / TECHNISCHE DATEN

NEW

NUOVE
ND
design

Patent Pending

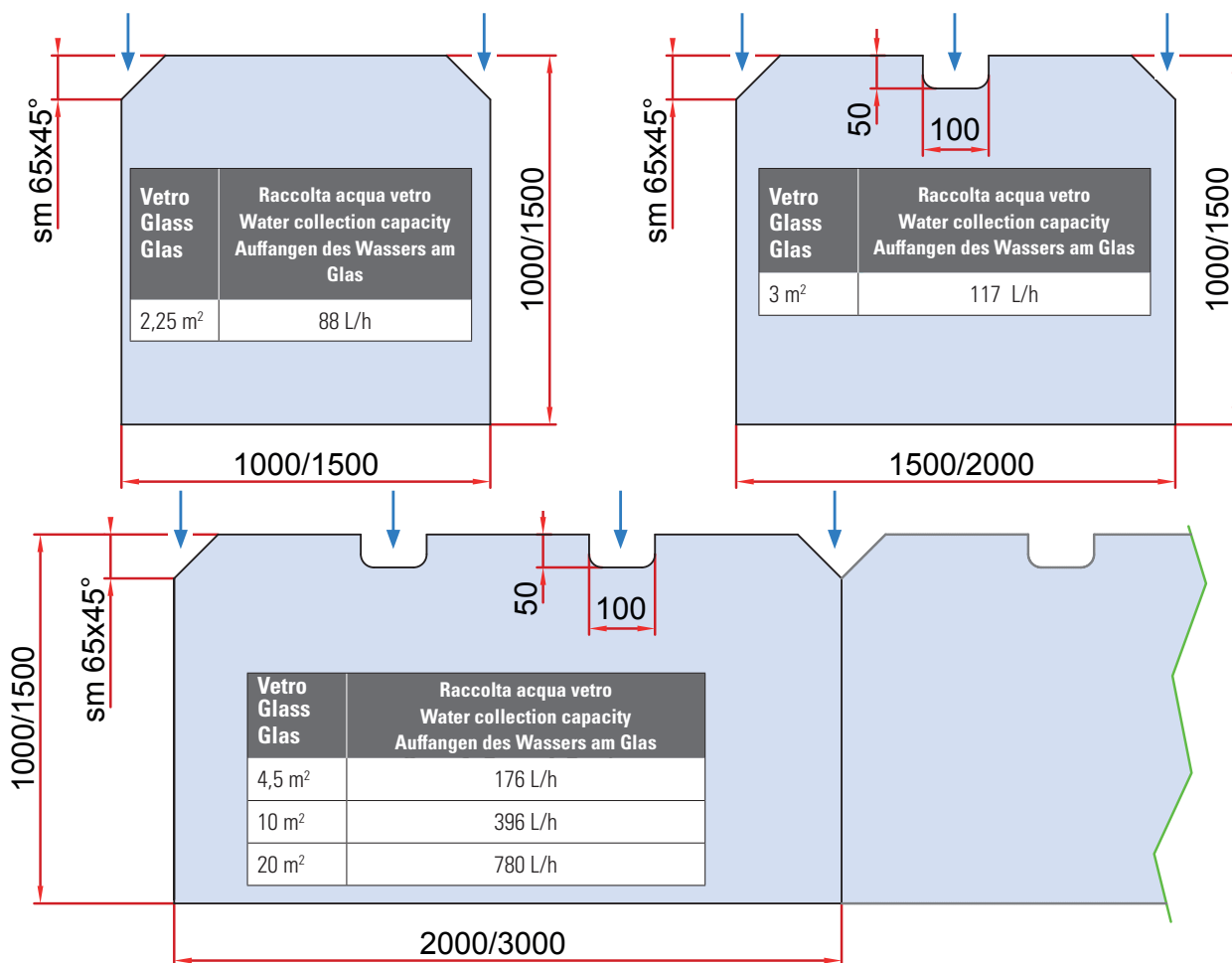

PENSILINE

CLASSIFICAZIONE DELLE PRECIPITAZIONI / RAINFALL CLASSIFICATION / EINTEILUNG DER NIEDERSCHLÄGE		
PiovigGINE / Drizzle / Nieselregen	1 mm/h	1 L/m ²
Pioggia debole / Light rain / Schwacher Regen	from 1 to 2 mm/h	from 1 to 2 L/m ²
Pioggia moderata / Steady rain / Mäßiger Regen	from 2 to 5 mm/h	from 2 to 5 L/m ²
Pioggia forte / Heavy rain / Starker Regen	from 6 to 9 mm/h	from 6 to 9 L/m ²
Rovescio / Downpour / Regenschauer	from 16 to 39 mm/h	from 16 to 39 L/m ²
Nubifragio / Storm / Wolkenbruch	40 mm/h	40 L/m ²

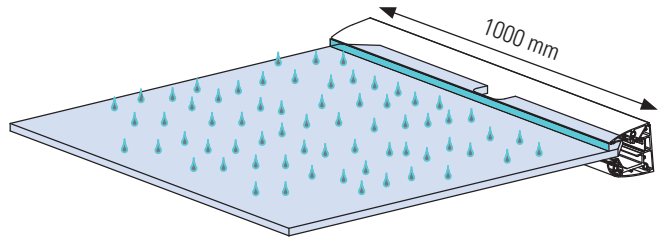
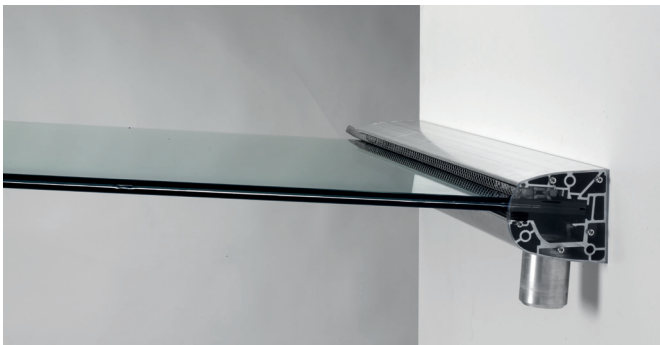

A

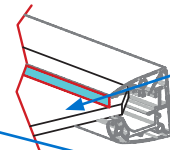
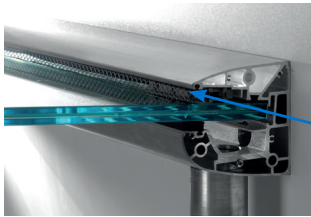

Capacità raccolta acqua L=1000 mm
Water collection capacity L=1000 mm
Auffangen des Wassers L=1000 mm
12000 mm² → 37440 L/h

B

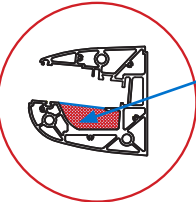
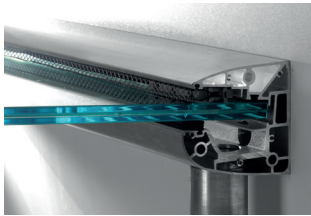

Capacità raccolta acqua con retina anti foglie L=1000 mm
Water collection capacity with grid L=1000 mm
Auffangen des Wassers L=1000 mm
6000 mm² → 18720 L/h

C

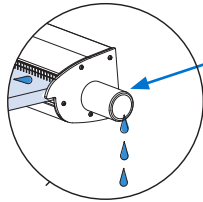
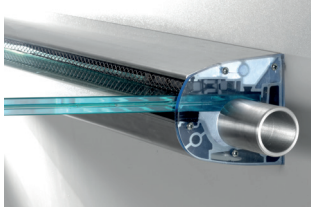

Capacità raccolta acqua:
Water collection capacity:
Auffangen des Wassers:
1320 mm² → 4104 L/h

D

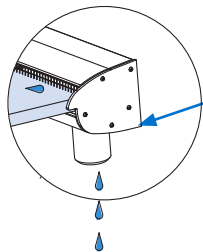
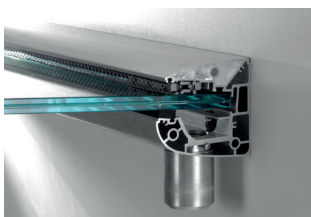

Capacità raccolta acqua:
Water collection capacity:
Auffangen des Wassers:
1260 mm² → 3924 L/h

E

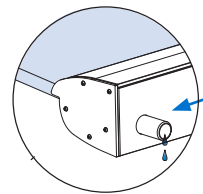

Capacità raccolta acqua:
Water collection capacity:
Auffangen des Wassers:
452 mm² → 1404 L/h

* With this solution is better to have 2 tubes

* Dati calcolati in laboratorio, secondo normativa UNI EN 12056 (coefficiente considerato di riempimento 0,33), senza presenza di detriti, foglie o altro. Per lunghi tratti verificare la fattibilità e l'esperienza.
* Data calculated in the laboratory, according to the UNI EN 12056 standard (coefficient considered with filling 0.33), without the presence of debris, leaves or other aspect. For long stretches check the feasibility and the experience.
* Daten im Labor berechnet, gemäß Norm EN 12056 (mit Füllkoeffizient 0,33), ohne Vorhandensein von Schutt, Blättern oder Sonstigem. Für lange Abschnitte sind Machbarkeit und Erfahrung zu prüfen.