

# CERNIERE TUTT'ALTEZZA

## HINGES PROFILES / BANDPROFILE



### P-08

€ E.376

- Cerniera tutt'altezza ad incollaggio per applicazione su stipiti battuta da 40 mm. Altezza standard cerniera 2400 mm.
- Hinge profile. Glass to be glued. For frames with rebate depth 40 mm. Hinge standard height 2400 mm.
- Bandprofil (Glas wird geklebt) für Falztiefe 40 mm. Band standard Höhe 2400 mm.

AN



L=2400 mm

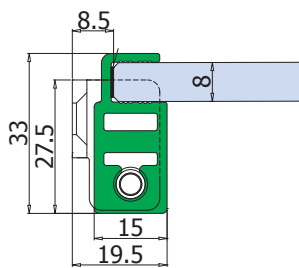
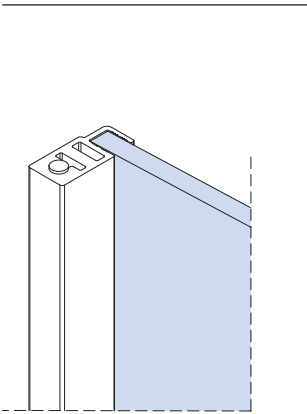
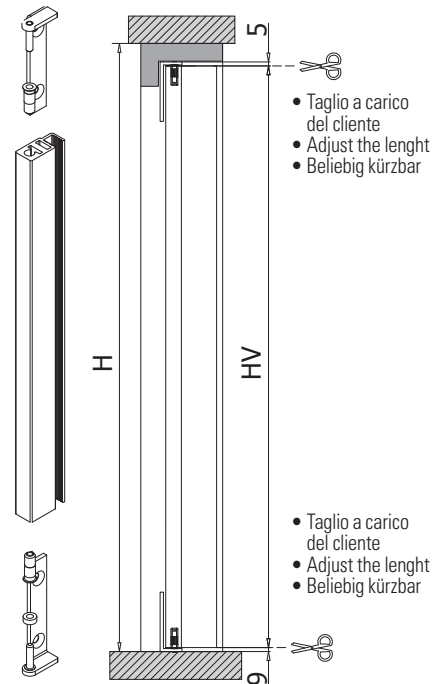

### SW DP 105 (3M) / SW DP 610 (3M)

- Adesivo strutturale consigliato.
- Suggested structural glue.
- Empfehlung Klebstoff.

### V-121-SD (incluso / included / enthalten)

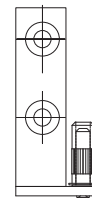
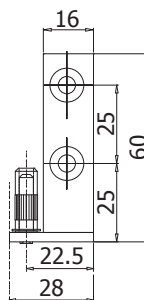

SX

DX

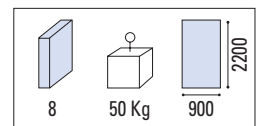

Cerniera applicabile ai seguenti stipiti / Hinge available for following frames / Band an folgende Zargen montierbar

### P-030 / P-040

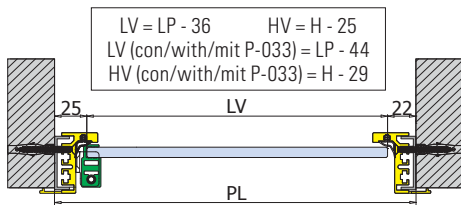
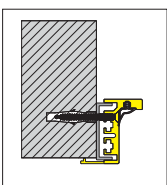

### TP-250

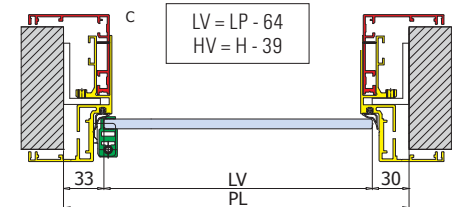
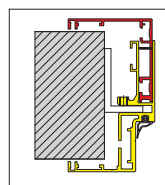

### TP-100

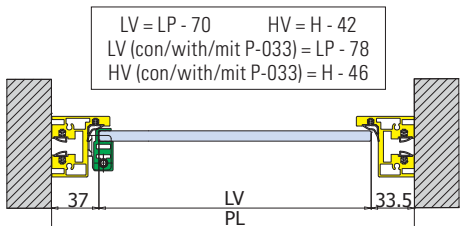
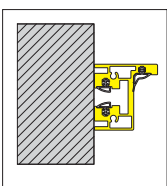

### P-070

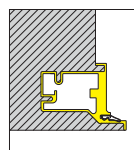

### P-060

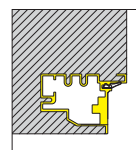

### TP-201

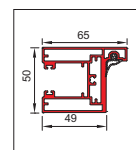

### TP-300

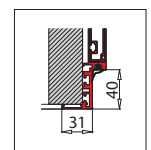

<b>LP</b> Passaggio luce Clear opening width Lichte Durchgangsbreite	<b>LV</b> Larghezza vetro Glass width Glasbreite	<b>HV</b> Altezza vetro Glass height Glashöhe	<b>H</b> Altezza passaggio luce Clear opening height Lichte durchgangshöhe
---	---	--	---

xme199I



**P-09**

€ E.379

- Cerniera tutt'altezza per applicazione su stipiti battuta da 40 mm. Altezza standard cerniera 2400 mm.
- Hinge profile. for frames with rebate depth 40 mm. Hinge standard height 2400 mm.
- Bandprofil für Falztiefe 40 mm. Band standard Höhe 2400 mm.

AN



L=2400 mm

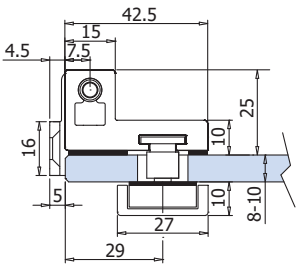
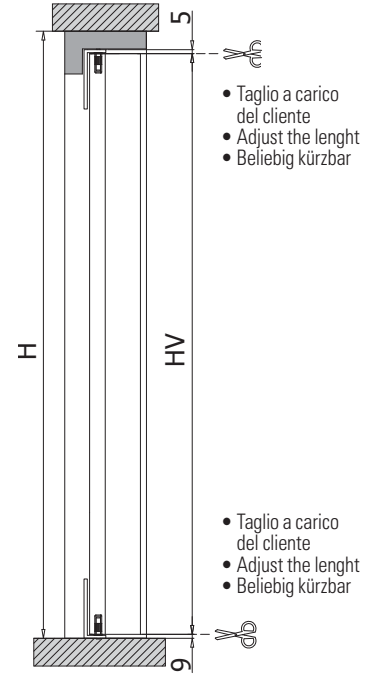

**LAVORAZIONE VETRO  
GLASS PREPARATION  
GLASBEARBEITUNG**

- I fori sul vetro possono essere posizionati a piacimento grazie alle bussole regolabili.
- The holes can be positioned at will thanks to the adjustable fixing points.
- Die Bohrungen können nach belieben durch die verstellbaren Befestigungspunkte positioniert werden.

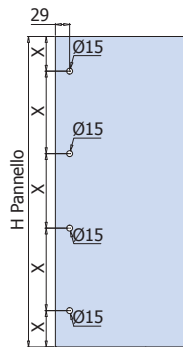
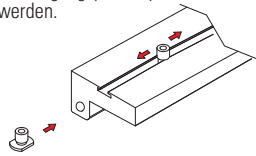

**V-122-SD** (incluso / included / enthalten)

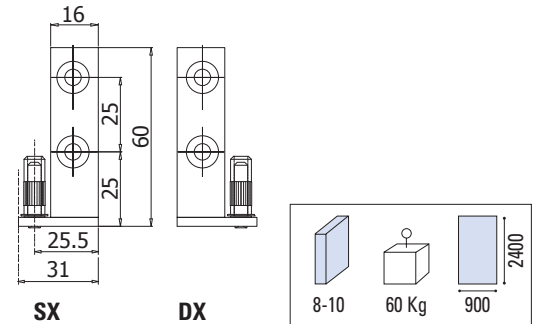

Cerniera applicabile ai seguenti stipiti / Hinge available for following frames / Band an folgende Zargen montierbar

**P-030 / P-040**

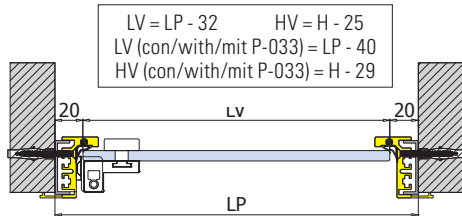
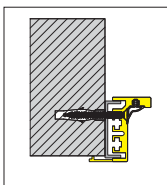

LV = LP - 32    HV = H - 25  
LV (con/with/mit P-033) = LP - 40  
HV (con/with/mit P-033) = H - 29

**TP-250**

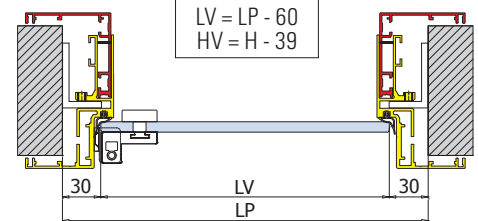
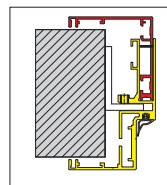

LV = LP - 60  
HV = H - 39

**TP-100**

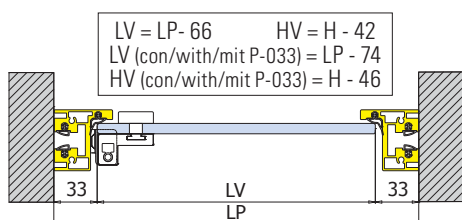
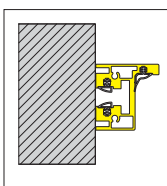

LV = LP - 66    HV = H - 42  
LV (con/with/mit P-033) = LP - 74  
HV (con/with/mit P-033) = H - 46

**P-070**

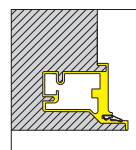

**P-060**

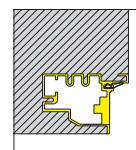

**TP-201**

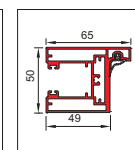

**TP-300**

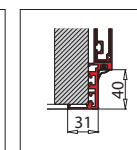

xme199c2 / xme199i

<b>LP</b> Passaggio luce Clear opening width Lichte Durchgangsbreite	<b>LV</b> Larghezza vetro Glass width Glasbreite	<b>HV</b> Altezza vetro Glass height Glashöhe	<b>H</b> Altezza passaggio luce Clear opening height Lichte durchgangshöhe
---	---	--	---