

PROFILI DI SCOLO

DRAINAGE PROFILES / DRAINAGELEISTEN

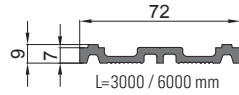

- BSA-20**
- Profili di scolo per balaustre B-8000 / B-8700
 - Drainage profile for profiles B-8000 / B-8700
 - Drainageleiste für Profile B-8000 / B-8700



- BSA-25**
- Profili di scolo per balaustre B-8600
 - Drainage profile for profile B-8600
 - Drainageleiste für Profil B-8600

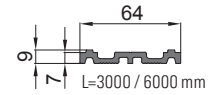

BSA-20 + B-8000

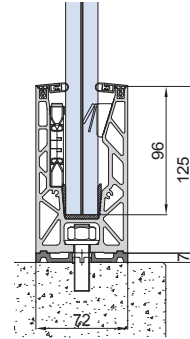

BSA-25 + B-8600

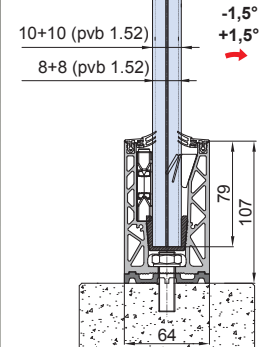

BSA-20 + B-8700

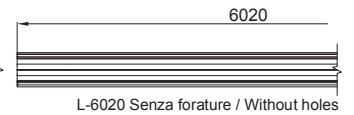
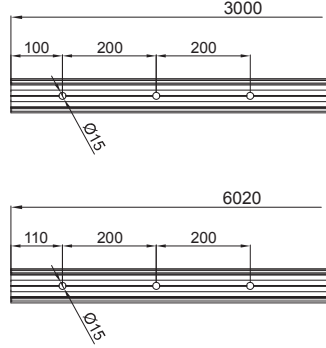
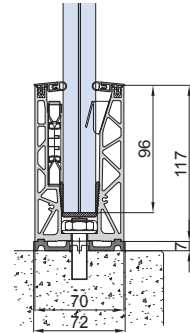
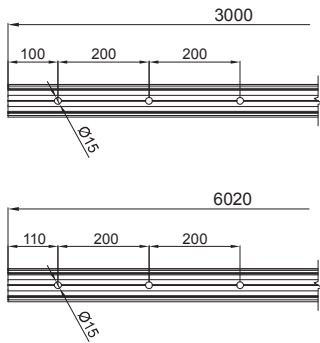

PAVIMENTO
A PEZZI

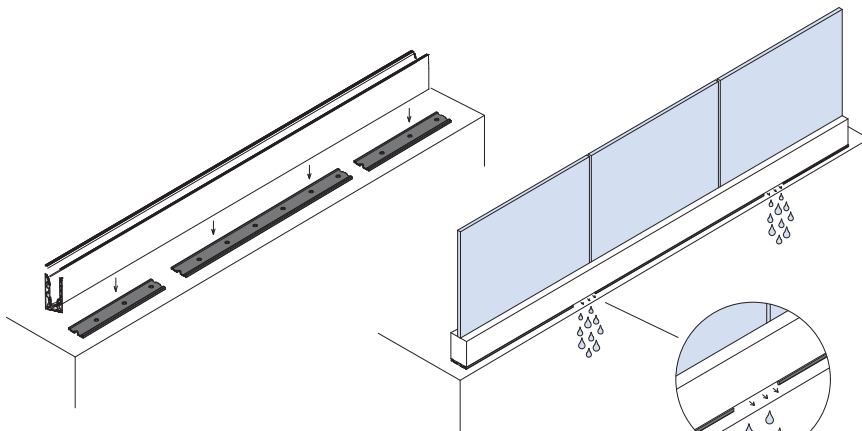

L'acqua drena da qui attraverso delle forature aggiuntive, poste nel profilo balaustre, all'interno del profilo a "U" sottostante e viene espulsa nella parte esterna dello stesso.
The water is drained through the additional holes, located in the railing profile, within the underlying U-shaped profile and it is expelled in the external part of the same.
Das Wasser fließt über zusätzliche Löcher ab, die sich im Profil des Geländers, im Inneren des darunterliegenden, U-förmigen Profils befindet, und tritt außen am Profil aus.

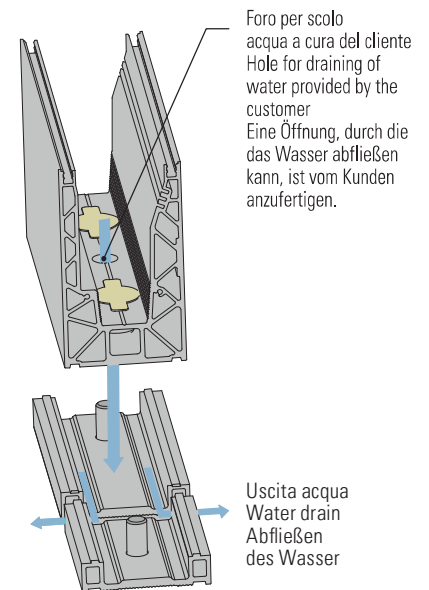
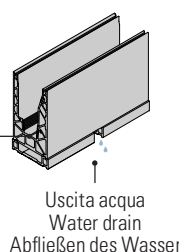

BWC-CMR 

- Kit Watercap utilizzabile solo con profili CMR
- Kit Watercap suitable only with CMR profiles
- Kit Watercap benutzbar nur mit CMR Profile

Foro per scolo acqua a cura del cliente in base all'installazione
Hole for draining of water provided by the customer based on the installation.
Eine Öffnung, durch die das Wasser abfließen kann, ist je nach Installation vom Kunden anzufertigen.

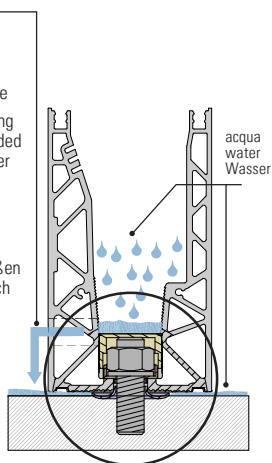

QUESTO SISTEMA EVITA L'INFILTRAZIONE D'ACQUA DAL PROFILO O DAL PAVIMENTO NEL PUNTO DI FISSAGGIO
THIS SYSTEM PREVENTS WATER INFILTRATION FROM THE PROFILE OR FLOOR
DIESES SYSTEM VERMEIDET DAS EINDRINGEN VON WASSER VOM PROFIL ODER VOM BODEN

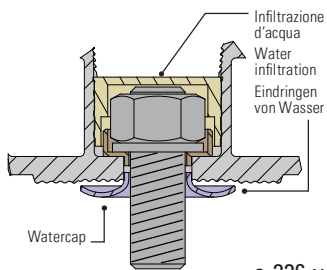
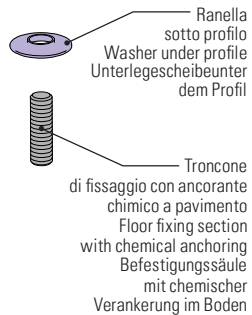
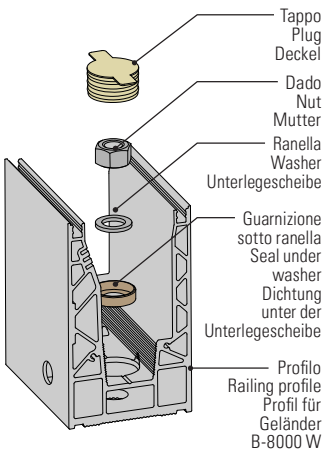

c-336-y

B-4111-CF8

- "Ombrellino" a molla anti infiltrazione vetro/vetro confezione di 8 pezzi
- "Umbrella" adjustable gasket with spring anti-filtration glass/glass package unit of 8 pieces
- Verstellbare Dichtung "Regenschirm" Glas/Glas gegen infiltration Verpackungseinheit von 8 Stück



8 pcs

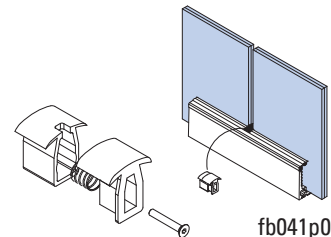
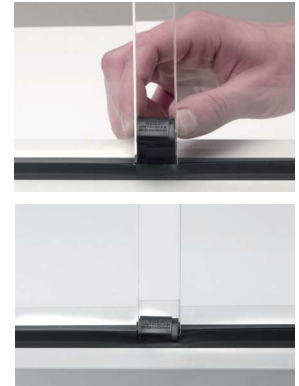
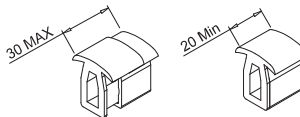
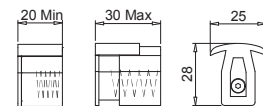

fb041p096

B-2009-10 mm

B-2009-20 mm

- Guarnizione anti infiltrazione vetro/vetro
- Gasket anti-filtration glass/glass
- Dichtung Glas/Glas gegen Infiltration

4 pcs



10 / 20 mm Standard
* + Misura a richiesta
+ Length on request
+ Länge auf Anfrage

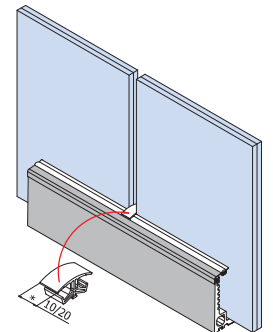

xfb033

PAVIMENTO
A PEZZI

B-6103

- Profili di scolo montaggio a pavimento e laterale per balastra.
- Drainage profiles floor and side installation for railing profiles.
- Drainageleisten Boden- und Seitenmontage für Geländerprofil.

AN



5 pcs

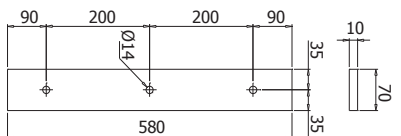
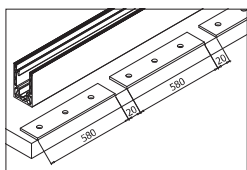
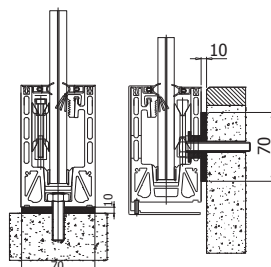

FB041P147-B6250

B-3015

- Profili di scolo montaggio a pavimento per balastra.
- Drainage profiles floor installation for railing profiles.
- Drainageleisten Bodenmontage für Geländerprofil.



15 pcs

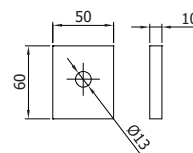
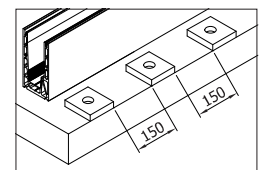
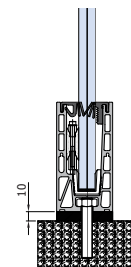

fb041-pc