

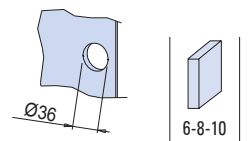

V-526

- Nicchia chiusa.
 - Closed sliding-handle.
 - Griffmuschel geschlossen.
- AN - CR - NS - NO - OR

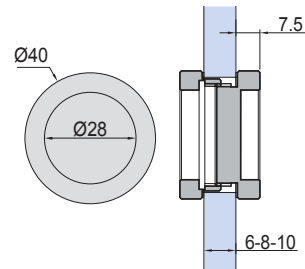

V-524

- Paio nicchie per scorrevole tonde, Ø 60
 - Materiale: ottone
 - Pair sliding door-handles, Ø 60
 - Material: brass
 - Paar Griffmuscheln, Ø 60
 - Material: Messing
- CP - NS - CR - NO

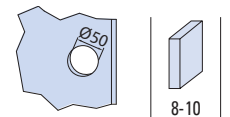
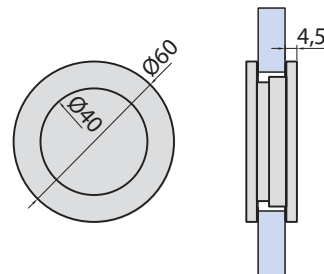

B-170

- Nicchia tonda Ø 55 mm per scorrevole.
 - Foro nel vetro Ø 45 mm.
 - Materiale: ottone
 - Sliding door-handle round Ø 55 mm.
 - Hole in glass Ø 45 mm.
 - Material: brass
 - Rund Griffmuschel Ø 55 mm.
 - Glas Bohrung Ø 45 mm.
 - Material: Messing
- CR

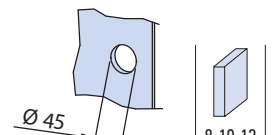
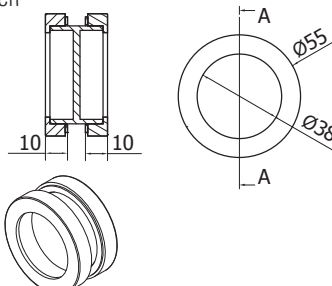

V-528

- Nicchia chiusa.
- Closed sliding-handle.
- Griffmuschel geschlossen.

AN - CR - NS

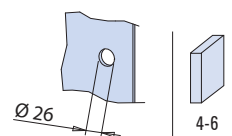
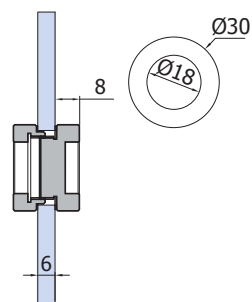
DIV-008

- Paio nicchie scorrevole ad incollaggio
- Pair sliding door-handles with self-adhesive fixing
- Paar Griffmuscheln selbstklebend

AN - NS - NO - BI - BC - BS - CR

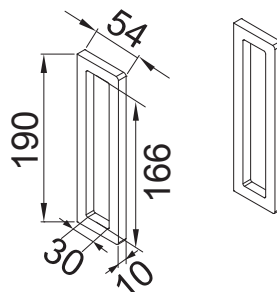

xme595m

DIV-007

- Paio nicchie scorrevole ad incollaggio
- Pair sliding door-handles with self-adhesive fixing
- Paar Griffmuscheln selbstklebend

AN - NS - NO - BI - BC - BS - CR

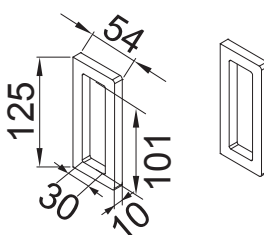

xme595m

NS
 Nickel satinato
 Satin nickel
 Ähnlich Edelstahl matt

CR
 Cromo lucido
 Polished chrome
 Chrom glänzend

CS
 Cromo satinato
 Satin chrome
 Chrom matt

OL
 Ottone lucido
 Polished brass
 Messing poliert

CP
 Cromo perla
 Chrome perla similar Alu
 Chrom perla ähnlich Alu

AN
 Alluminio anodizzato
 Aluminium anodized
 Aluminium Silberfarbig

NO
 Nero opaco
 Matt black
 Schwarz matt