

EVOLUTION

V-5100

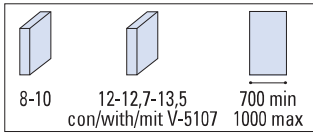

V-5150

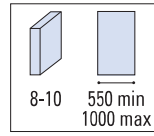

COMPONENTI | COMPONENTS | EINZELTEILE ▶ 24



V-5100

V-5102 120 Kg

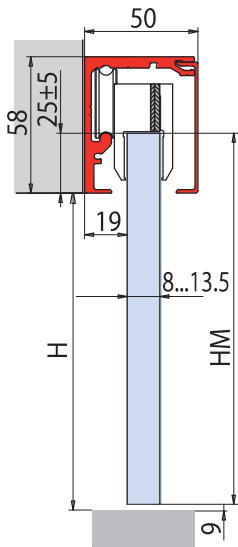
V-5152 70 Kg

V-012
V-5101

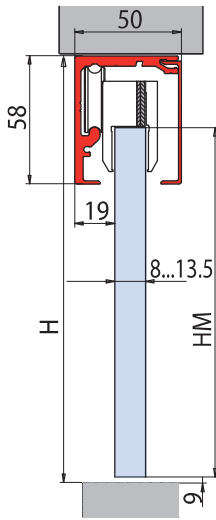
$$HM = H + 16$$



$$HM = H - 43$$

V-5100 | V-5150 SET 1

- Set per 1 anta scorrevole, fissaggio a parete/soffitto
- Sliding door set, wall/ceiling installation
- Schiebetürset 1-flügelig, Wand-Deckenmontage

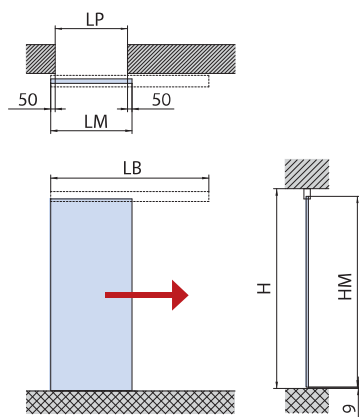

$$LB = LP \times 2 + 150$$

$$LM = LP + 100$$

V-5100 | V-5150 SET 2

- Set per 2 ante scorrevoli, fissaggio a parete/soffitto
- Sliding doors set, wall/ceiling installation
- Schiebetürset 2-flügelig, Wand-Deckenmontage

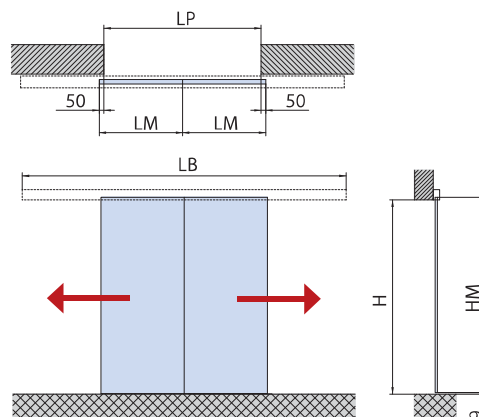

$$LB = LP \times 2 + 100$$

$$LM = (LP + 100) / 2$$

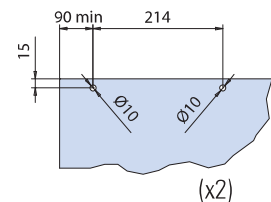
LAVORAZIONE VETRO
GLASS PREPARATION
GLASBEARBEITUNG

(x2)

- Fori optional per V-5102
- Holes optional for V-5102
- Bohrungen Optional für V-5102

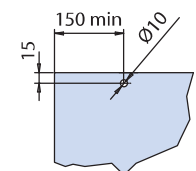

(x2)

- Foro optional per V-5152
- Hole optional for V-5152
- Bohrung Optional für V-5152

xla209 / xla281c

Cod.	Fin. Fin. Oberf.	V-5100 SET 1 FIX	V-5100 SET 1-MIS	V-5100 SET 2 FIX	V-5100 SET 2-MIS	V-5150 SET 1 FIX	V-5150 SET 1-MIS	V-5150 SET 2 FIX	V-5150 SET 2-MIS
V-5100 L=2000 L=2500 L=3000 L=4000 L=6000	AN / IXE	1	-	1	-	1	-	1	-
V-5100-MIS L=1500 → 6000	AN / IXE	-	1	-	1	-	1	-	1
V-5102	-	1	1	2	2	-	-	-	-
V-5152	-	-	-	-	-	1	1	2	2
V-5101	AN / IXE	1	1	1	1	1	1	1	1
V-012	AN / NS	1	1	2	2	1	1	2	2

EVOLUTION

V-5103

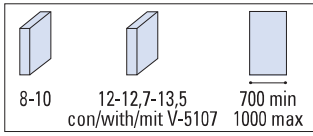

V-5153

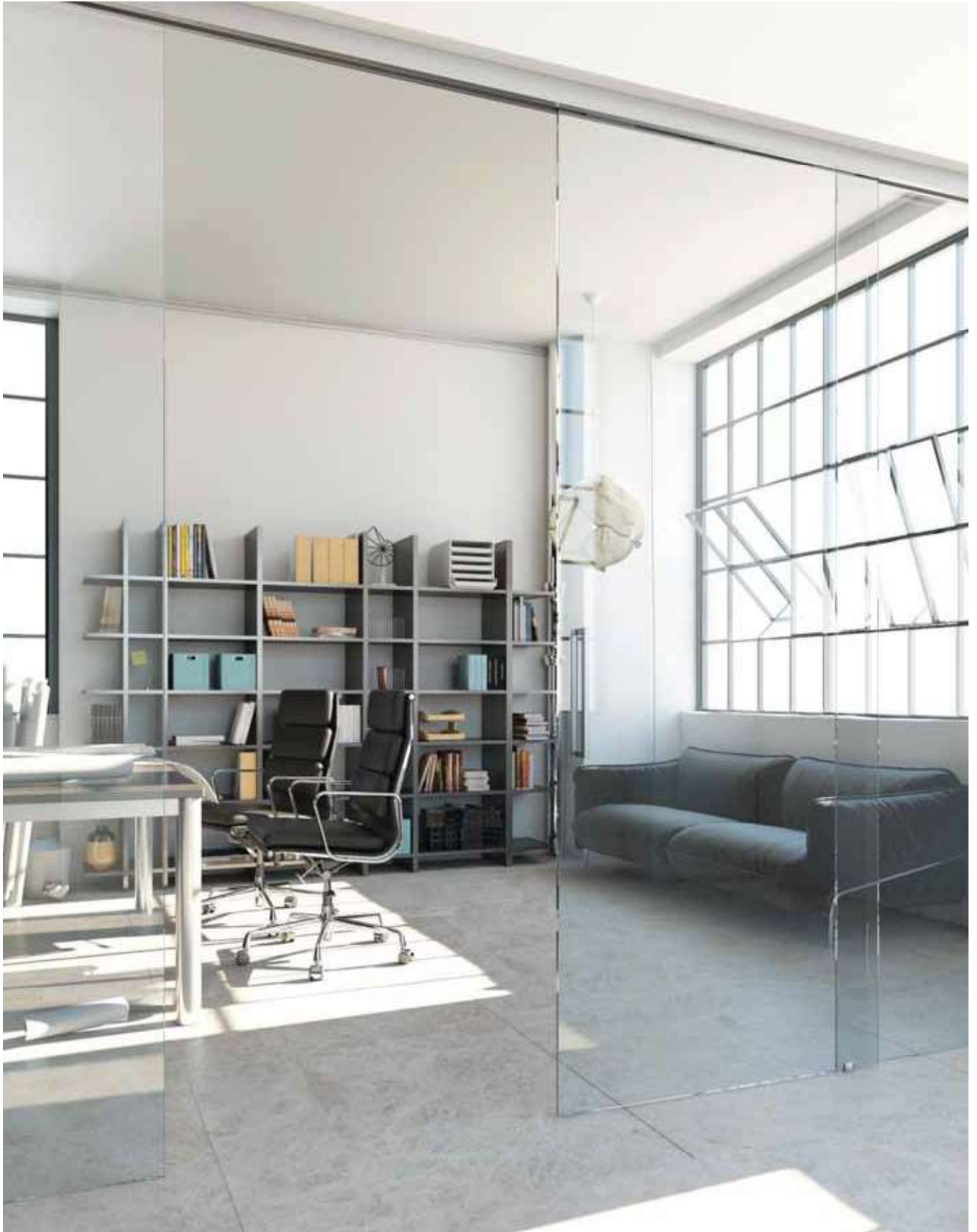
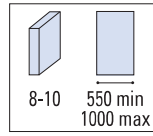

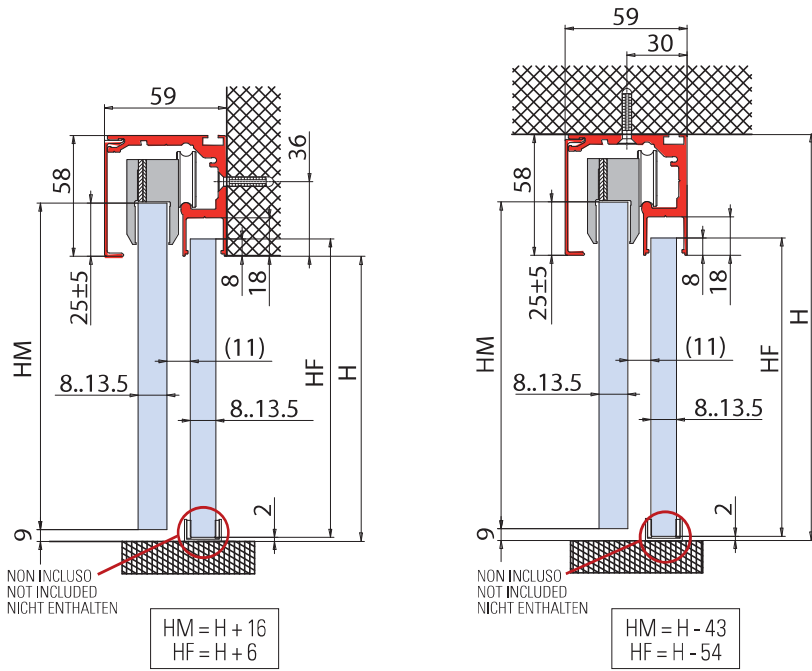
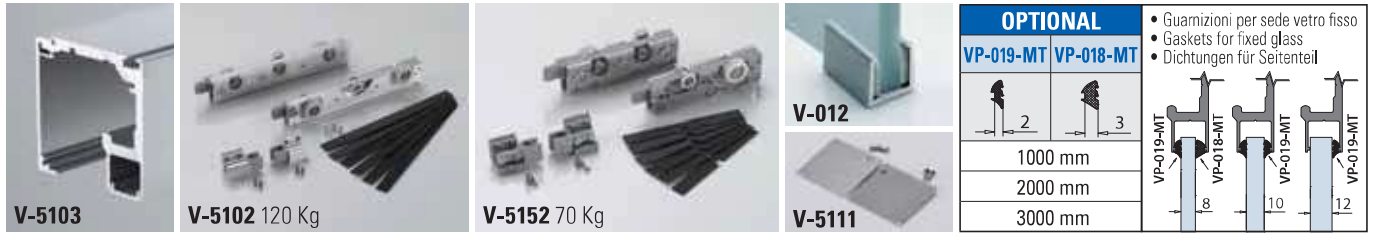
COMPONENTI | COMPONENTS | EINZELTEILE ▶ 24

V-5103 | V-5153 SET 1

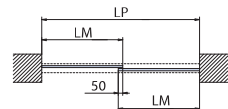
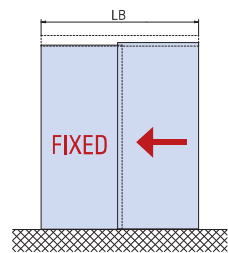
- Set per 1 anta scorrevole e vetro fisso, fissaggio a parete/soffitto
- Sliding door set with fixed panel, wall/ceiling installation
- Schiebetürset 1-flügelig mit Seitenteil, Wand-Deckenmontage

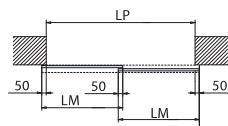

$$LB = LP$$

$$LM = (LP + 50) / 2$$



$$LB = LP + 100$$

$$LM = (LP + 150) / 2$$

V-5103 | V-5153 SET 2

- Set per 2 ante scorrevole e vetri fissi, fissaggio a parete/soffitto
- Sliding doors set with fixed panels, wall/ceiling installation
- Schiebetürset 2-flügelig mit Seitenteil, Wand-Deckenmontage

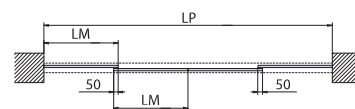
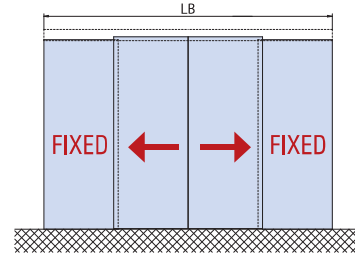

$$LB = LP$$

$$LM = (LP + 100) / 4$$

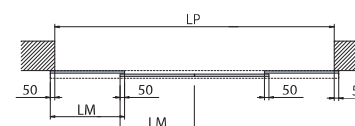

$$LB = LP + 100$$

$$LM = (LP + 200) / 4$$

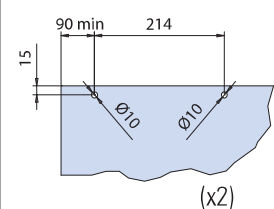
**LAVORAZIONE VETRO
GLASS PREPARATION
GLASBEARBEITUNG**

- Fori optional per V-5102
- Holes optional for V-5102
- Bohrungen Optional für V-5102

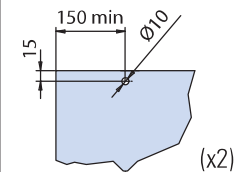

- Foro optional per V-5152
- Hole optional for V-5152
- Bohrung Optional für V-5152

xla213 / xla214 / xla215

Cod.	Fin. Fin. Oberf.	V-5103 SET 1 FIX	V-5103 SET 1-MIS	V-5103 SET 2 FIX	V-5103 SET 2-MIS	V-5153 SET 1 FIX	V-5153 SET 1-MIS	V-5153 SET 2 FIX	V-5153 SET 2-MIS
V-5103 L=2000 L=2500 L=3000 L=4000 L=6000	AN / IXE	1	-	1	-	1	-	1	-
V-5103-MIS L=1500 → 6000	AN / IXE	-	1	-	1	-	1	-	1
V-5102	-	1	1	2	2	-	-	-	-
V-5152	-	-	-	-	-	1	1	2	2
V-012	AN / NS	1	1	2	2	1	1	2	2
V-5111 (OPTIONAL)	AN / IXE	(1)	(1)	(1)	(1)	(1)	(1)	(1)	(1)

V-5100 | V-5103 | V-5150 | V-5153 | V-5140 EVOLUTION

COMPONENTI | COMPONENTS | EINZELTEILE



V-5100

- Binario Evolution
 - Track profile Evolution
 - Laufschiene Evolution
- AN-IXE

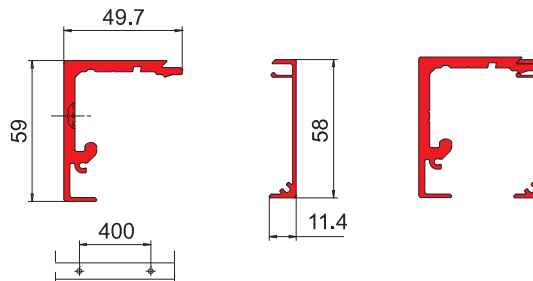

xfb-067



V-5103

- Binario Evolution per anta scorrevole con vetro fisso laterale
 - Track profile Evolution for sliding panel and fixed side panel
 - Laufschiene Evolution für Schiebetür und Seitenteil
- AN-IXE

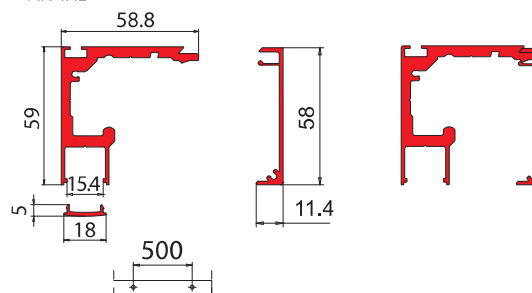

xfb-067



V-5102

- Set accessori per 1 anta scorrevole composto da: n° 2 carrelli, morsetti per vetro 8-10 mm, n° 2 stoppers
- Accessories set for 1 sliding panel consisting of: n° 2 roller carriers for 8/10 mm glass, n° 2 stoppers
- Zubehör für 1 Schiebetür bestehend aus: n° 2 Klemm - Laufwagen für 8/10 mm Glas, n° 2 Stopper

120 Kg

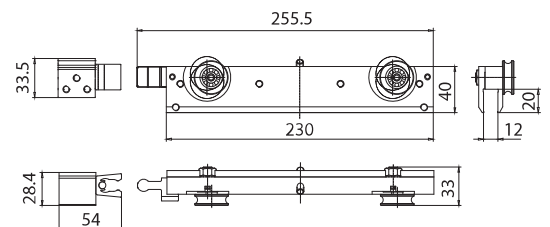

xme508i

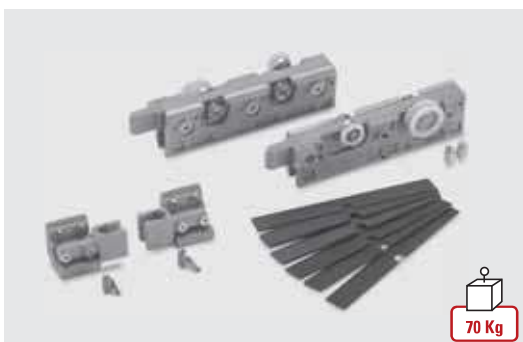

V-5152

- Set accessori per 1 anta scorrevole composto da: n° 2 carrelli, morsetti per vetro 8-10 mm, n° 2 stoppers
- Accessories set for 1 sliding panel consisting of: n° 2 roller carriers for 8/10 mm glass, n° 2 stoppers.
- Zubehör für 1 Schiebetür bestehend aus: n° 2 Klemm - Laufwagen für 8/10 mm Glas, n° 2 Stopper

70 Kg

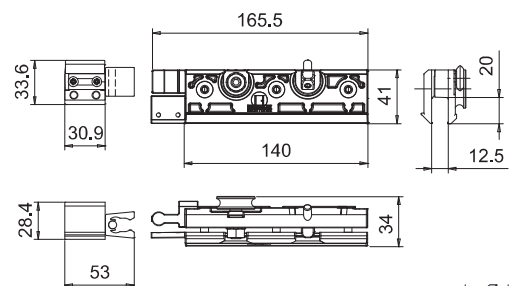

xme508l



V-5006

- Punto per fissaggio a vetro fisso della guida V-5100
- Point fitting to fix track profile V-5100 on glass
- Punktbefestigung für Glasmontage Schiene V-5100

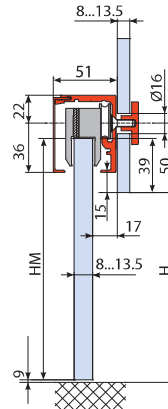
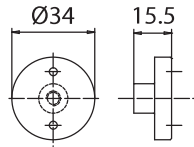
AN - IXE

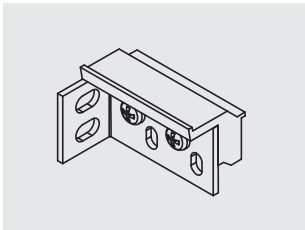

xla-211

V-5112

- N° 1 Staffa Evolution autoportante reversibile DX-SX per fissaggio laterale binario V-5403/muro
- 1 pcs bracket for side fixing evolution profile V-5403
- 1 Stuck winkelprofil für Seitliche Wandbefestigung Evolution Laufschiene V-5403

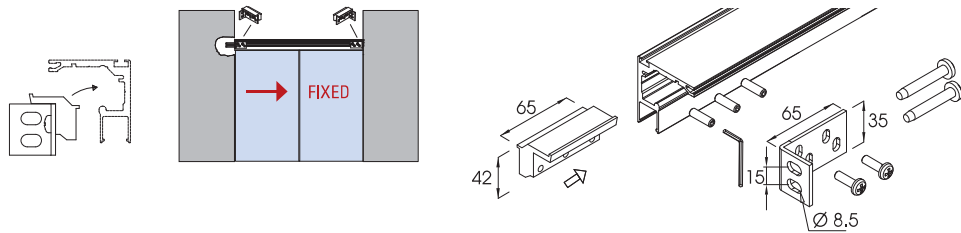

xme146

V-5101

- Paio tappi finali in plastica per guida a scorrimento V-5100
- Pair plastic endcaps for track profile V-5100
- Paar Endkappenn aus Kunststoff für Laufschiene V-5100

AN - IXE

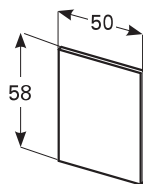

xla-209



V-5111

- Paio tappi finali in alluminio per guida a scorrimento V-5103
- Pair aluminium endcaps for track profile V-5103
- Paar Endkappenn aus Aluminium für Laufschiene V-5103

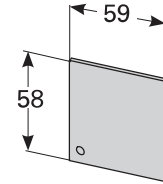
AN - IXE

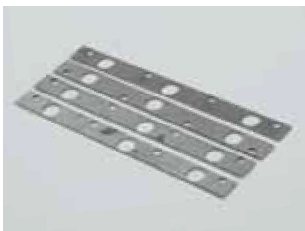

xla-209

V-5107

- Set per spessori vetro 12 - 12,7 - 13,5 (per 2 pinze V-5102)
- Set spacers for glass thickness 12 - 12,7 - 13,5 (for 2 clamps V-5102)
- Set distanzscheiben für Glasdicke 12 - 12,7 - 13,5 (für 2 Klemm-Lauwagen V-5102)

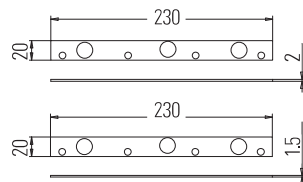
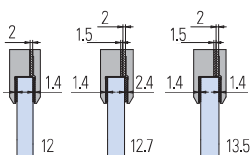

xla209b

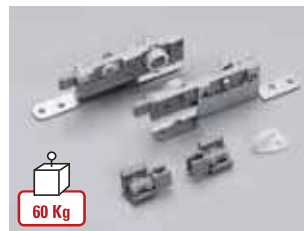
V-5142

- Set accessori per 1 anta scorrevole in legno composto da: 2 carrelli, morsetti per porte legno, 2 stopper
- Accessory set for 1 sliding wooden door panel consisting of 2 roller carriers for wooden door, 2 stoppers
- Zubehör komplett für 1 Holz Schiebetür bestehend aus: N° 2 Klemm - Lauwagen für Holztür, 2 Stoppers

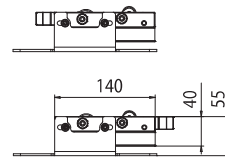
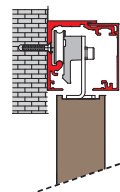

xla355

V-5100 | V-5103 | V-5150 | V-5153 | V-5140 EVOLUTION

COMPONENTI | COMPONENTS | EINZELTEILE



V-5307

- Set staffe per fissaggio carrelli Evolution V-5102 con pannello legno
- Pair suspension plates hanger for Evolution clamps V-5102 with wooden doors
- Paar Winkel für Evolution Laufwagen V-5102 mit Holztüren

2 pcs

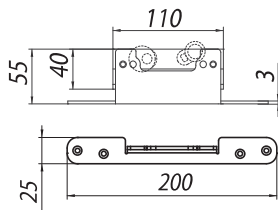

xla355



V-5507

- Set staffe per fissaggio carrelli Evolution V-5152 con pannello legno
- Pair suspension plates hanger for Evolution clamps V-5152 with wooden doors
- Paar Winkel für Evolution Laufwagen V-5152 mit Holztüren

2 pcs

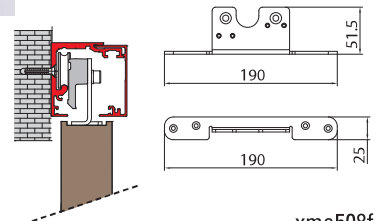

xme508f

V-5110

- Extra montaggio kit Evolution per chiusura simultanea 2 ante. Larghezza minima anta 600 mm (senza fori di sicurezza vetro)
- Extra cost for kit 2 panels synchronously opening. Min. door width 600 mm (without security holes in glass)
- Aufpreis Set für 2 Synchron öffnende Schiebeteile. Min. Flügelbreite 600 mm (ohne Sicherheitsbohrungen in Glas)

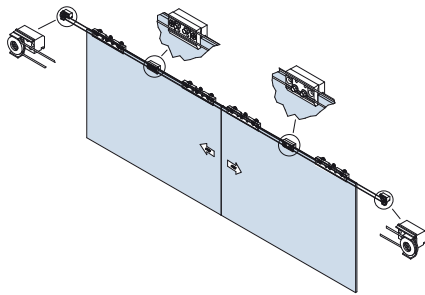

xme-094

OPTIONAL		
VP-019-MT	VP-018-MT	
2	3	
1000 mm - 2000 mm - 3000 mm		
<ul style="list-style-type: none"> • Guarnizioni per sede vetro fisso • Gaskets for fixed glass • Dichtungen für Seitenteil 		
8	10	12