

# DIV-030 (WITH P-033)

HS STIPIITE | Frame profile height      H VANO | Dimension of opening height      LS STIPIITE | Frame profile width      LP VANO | Dimension of opening width

LEFT - Nr.

LP VANO (mm):       H VANO (mm):

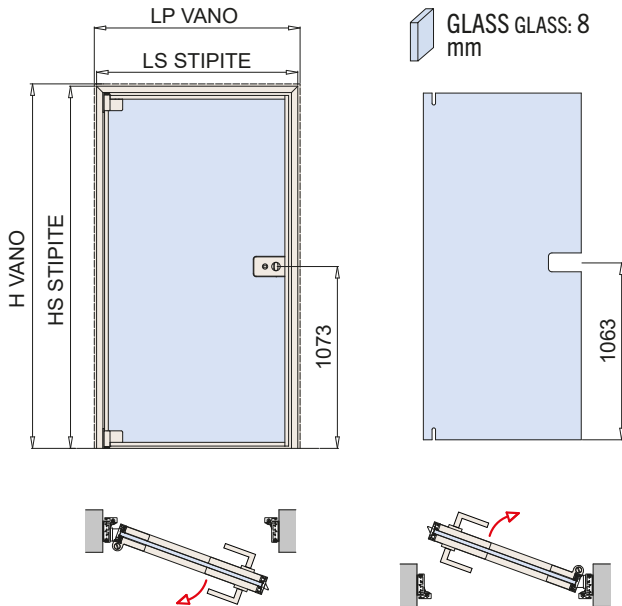

RIGHT - Nr.

LP VANO (mm):       H VANO (mm):

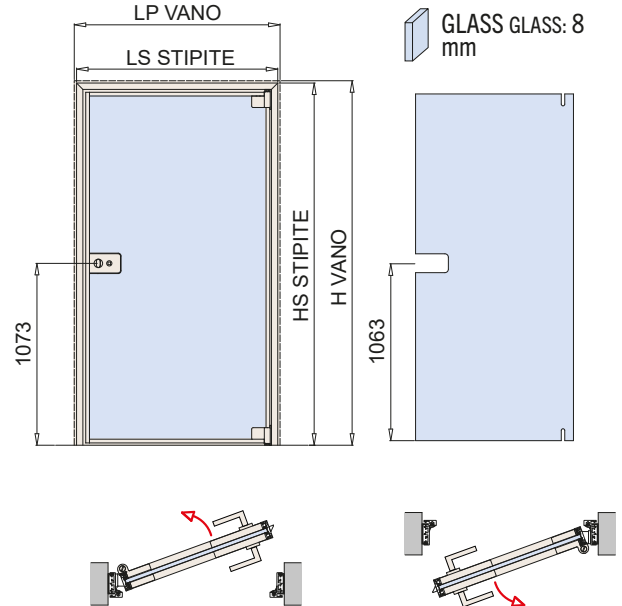

STANDARD SET – complete with frame, hinges, locks, cylinders, handles, strike plates, and frame machining

PRODUCT CODE	LOCKS + STRIKE PLATE	
	V-740	CP-015
<input type="checkbox"/> DIV-030-033-740-2500 HS = 2500 mm		
<input type="checkbox"/> DIV-030-033-740-2950 HS = 2950 mm		
	V-741	CP-015
<input type="checkbox"/> DIV-030-033-741-2500 HS = 2500 mm		
<input type="checkbox"/> DIV-030-033-741-2950 HS = 2950 mm		
	DIV-M101	CP-016
<input type="checkbox"/> DIV-030-033-101-2500 HS = 2500 mm		
<input type="checkbox"/> DIV-030-033-101-2950 HS = 2950 mm		

## SURCHARGES OPTIONAL

PRODUCT CODE	LOCKS + STRIKE PLATE	
	V-740	CP-015
<input type="checkbox"/> SUP-SER-740WC		
	M-740-WC	CP-015-M
<input type="checkbox"/> SUP-SER-M740WC		
	M-740	CP-015-M
<input type="checkbox"/> SUP-SER-M740		
	M-741	CP-015-M
<input type="checkbox"/> SUP-SER-M741		

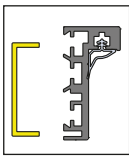

# DIV-030 (WITH WITH P-033) 2FLG DOUBLE DOOR

ONLY STANDARD PROFILE PREPARATION AVAILABLE. THE MEASUREMENTS INDICATED ON THE FORM ATTACHED TO THE ORDER ARE EXECUTIVE FOR PRODUCTION

HS STIPIITE | Frame profile height      H VANO | Dimension of opening height      LS STIPIITE | Frame profile width      LP VANO | Dimension of opening width

LEFT - Nr.

LP VANO (mm):       H VANO (mm):

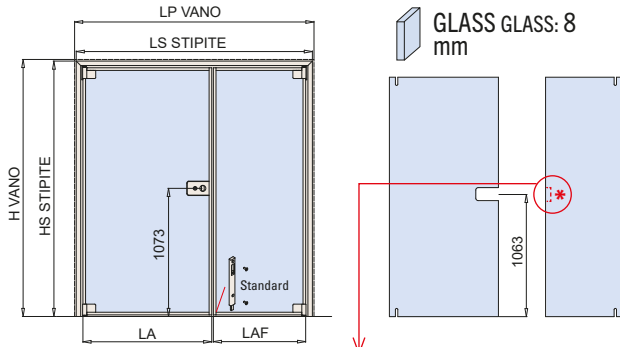

\*tacca SOLO per versione magnetica  
glass preparation ONLY for magnetic locks

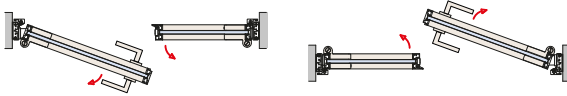

RIGHT - Nr.

LP VANO (mm):       H VANO (mm):

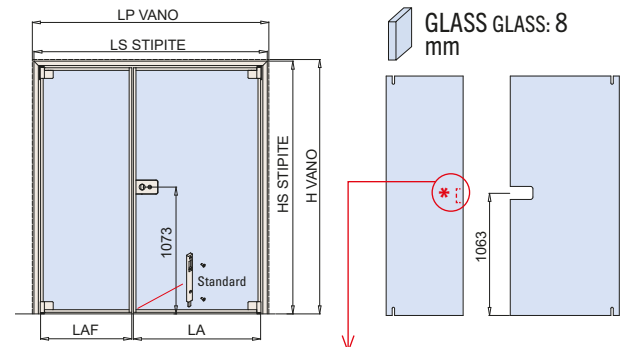

\*tacca SOLO per versione magnetica  
glass preparation ONLY for magnetic locks

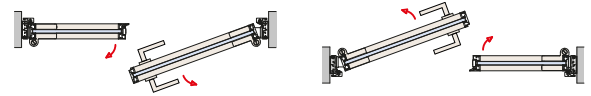

STANDARD SET – complete with frame, hinges, locks, cylinders, handles, strike plates, and frame machining

PRODUCT CODE	LOCKS + STRIKE PLATE	
	V-740	DIV-005
<input type="checkbox"/> DIV-030-033-2FL-740-2500 HS = 2500 mm		
<input type="checkbox"/> DIV-030-033-2FL-740-2950 HS = 2950 mm		
	V-741	DIV-005
<input type="checkbox"/> DIV-030-033-2FL-741-2500 HS = 2500 mm		
<input type="checkbox"/> DIV-030-033-2FL-741-2950 HS = 2950 mm		
	DIV-M101	CP-016
<input type="checkbox"/> DIV-030-033-2FL-101-2500 HS = 2500 mm		
<input type="checkbox"/> DIV-030-033-2FL-101-2950 HS = 2950 mm		

## SURCHARGES OPTIONAL

PRODUCT CODE	UPPER LOCKING BOLT	
<input type="checkbox"/> DIV-003 (superiore)		
PRODUCT CODE	LOCKS + STRIKE PLATE	
	V-740	CP-015
<input type="checkbox"/> SUP-SER-740WC		
	M-740-WC	CP-015-M
<input type="checkbox"/> SUP-SER-M740WC		
	M-740	CP-015-M
<input type="checkbox"/> SUP-SER-M740		
	M-741	CP-015-M
<input type="checkbox"/> SUP-SER-M741		
	M-101-DOP	CP-016
<input type="checkbox"/> SUP-M101-DOP		

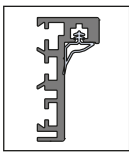

# DIV-030 (WITHOUT WITHOUT P-033)

ONLY STANDARD PROFILE PREPARATION AVAILABLE. THE MEASUREMENTS INDICATED ON THE FORM ATTACHED TO THE ORDER ARE EXECUTIVE FOR PRODUCTION

<b>HS STIPITE</b>	Frame profile height	<b>H VANO</b>	Dimension of opening height	<b>LS STIPITE</b>	Frame profile width	<b>LP VANO</b>	Dimension of opening width
-------------------	----------------------	---------------	-----------------------------	-------------------	---------------------	----------------	----------------------------

**LEFT - Nr.**

**LP VANO (mm):**       **H VANO (mm):**

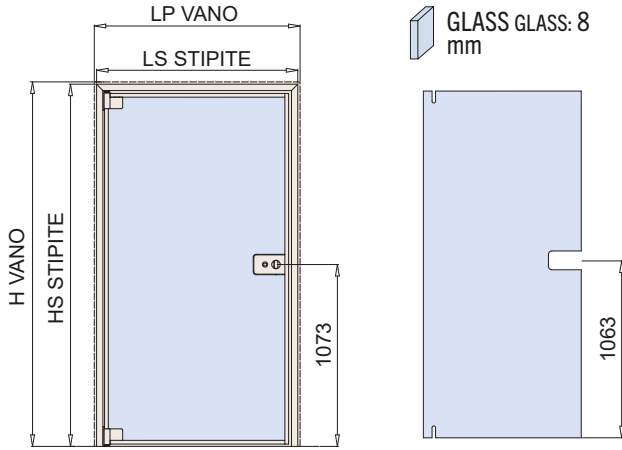

**RIGHT - Nr.**

**LP VANO (mm):**       **H VANO (mm):**

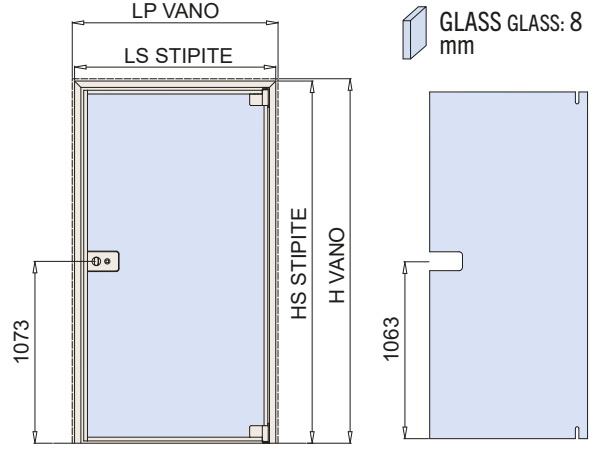

**STANDARD SET** – complete with frame, hinges, locks, cylinders, handles, strike plates, and frame machining

PRODUCT CODE	LOCKS + STRIKE PLATE	
<input type="checkbox"/> <b>DIV-030-740-2500</b> HS = 2500 mm	V-740	CP-015
<input type="checkbox"/> <b>DIV-030-740-2950</b> HS = 2950 mm		
<input type="checkbox"/> <b>DIV-030-741-2500</b> HS = 2500 mm	V-741	CP-015
<input type="checkbox"/> <b>DIV-030-741-2950</b> HS = 2950 mm		
<input type="checkbox"/> <b>DIV-030-101-2500</b> HS = 2500 mm	DIV-M101	CP-016
<input type="checkbox"/> <b>DIV-030-101-2950</b> HS = 2950 mm		

## SURCHARGES OPTIONAL

PRODUCT CODE	LOCKS + STRIKE PLATE	
<input type="checkbox"/> <b>SUP-SER-740WC</b>	V-740	CP-015
<input type="checkbox"/> <b>SUP-SER-M740WC</b>	M-740-WC	CP-015-M
<input type="checkbox"/> <b>SUP-SER-M740</b>	M-740	CP-015-M
<input type="checkbox"/> <b>SUP-SER-M741</b>	M-741	CP-015-M

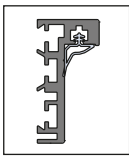

# DIV-030 (WITHOUT WITHOUT P-033) 2FLG DOUBLE DOOR

ONLY STANDARD PROFILE PREPARATION AVAILABLE. THE MEASUREMENTS INDICATED ON THE FORM ATTACHED TO THE ORDER ARE EXECUTIVE FOR PRODUCTION

HS STIPIITE	Frame profile height	H VANO	Dimension of opening height	LS STIPIITE	Frame profile width	LP VANO	Dimension of opening width
-------------	----------------------	--------	-----------------------------	-------------	---------------------	---------	----------------------------

LEFT - Nr.

LP VANO (mm):  H VANO (mm):

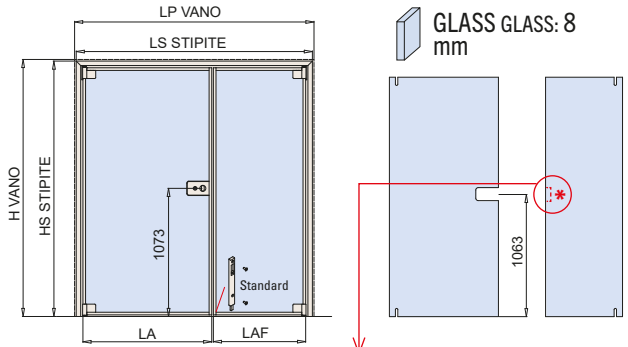

\*tacca SOLO per versione magnetica  
glass preparation ONLY for magnetic locks

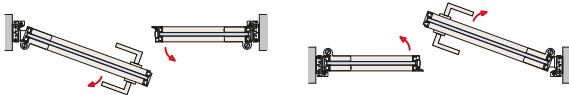

RIGHT - Nr.

LP VANO (mm):  H VANO (mm):

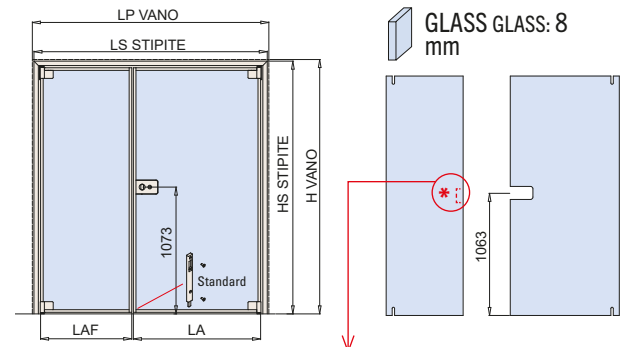

\*tacca SOLO per versione magnetica  
glass preparation ONLY for magnetic locks

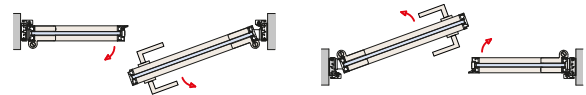

STANDARD SET – complete with frame, hinges, locks, cylinders, handles, strike plates, and frame machining

PRODUCT CODE	LOCKS + STRIKE PLATE	
	V-740	DIV-005
<input type="checkbox"/> DIV-030-2FL-740-2500 HS = 2500 mm		
<input type="checkbox"/> DIV-030-2FL-740-2950 HS = 2950 mm		
	V-741	DIV-005
<input type="checkbox"/> DIV-030-2FL-741-2500 HS = 2500 mm		
<input type="checkbox"/> DIV-030-2FL-741-2950 HS = 2950 mm		
	DIV-M101	CP-016
<input type="checkbox"/> DIV-030-2FL-101-2500 HS = 2500 mm		
<input type="checkbox"/> DIV-030-2FL-101-2950 HS = 2950 mm		

## SURCHARGES OPTIONAL

PRODUCT CODE	UPPER LOCKING BOLT	
<input type="checkbox"/> DIV-003 (superiore)		
PRODUCT CODE	LOCKS + STRIKE PLATE	
	V-740	CP-015
<input type="checkbox"/> SUP-SER-740WC		
	M-740-WC	CP-015-M
<input type="checkbox"/> SUP-SER-M740WC		
	M-740	CP-015-M
<input type="checkbox"/> SUP-SER-M740		
	M-741	CP-015-M
<input type="checkbox"/> SUP-SER-M741		
	M-101-DOP	CP-016
<input type="checkbox"/> SUP-M101-DOP		