

**EASY (OPTIONAL SOFT-CLOSE)**



**V-1000 / V-1010 / V-1020**



100 Kg



8-10



8,76/10,76/12  
12,76/13,52  
con V-1817



550 min



SIMPLE

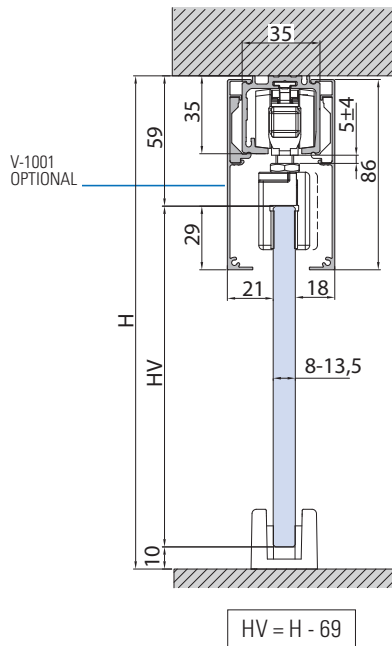
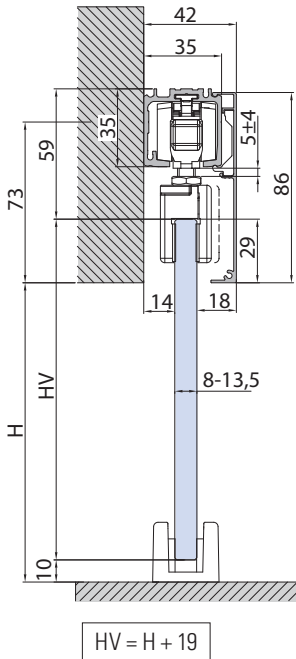

**COMPONENTI / COMPONENTS / EINZELTEILE**

- Fori vetro sicurezza **optional**
- Security glass holes **optional**
- Sicherheitsbohrungen **optional**

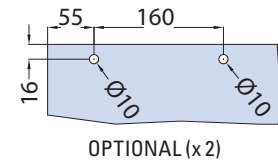
**V-1006-D70 SOFT-CLOSE**

	Soft-close chiusura / apertura double acting dapplet Wirkende	Fori optional Optional holes Bohrungen optional
<b>min 790</b>	1	☒

**V-1006-80 SOFT-CLOSE**

	Soft-close solo chiusura single acting einzeln Wirkende	Fori optional Optional holes Bohrungen optional
<b>min 635</b>	1	☒

**V-1006-D100 SOFT-CLOSE**

	Soft-close chiusura / apertura double acting dapplet Wirkende	Fori optional Optional holes Bohrungen optional
<b>min 900</b>	1	☒

**V-1000 / V-1010 / V-1020 SET 1**

- Set per 1 anta scorrevole, fissaggio a parete/soffitto (solo 1 veletta inclusa)
- Sliding door set, wall/ceiling installation (only 1 cover included)
- Schiebetürset 1-flügelig, Wand-Deckenmontage (nur 1 Abdeckung enthalten)

**V-1000 / V-1010 / V-1020 SET 2**

- Set per 2 ante scorrevoli, fissaggio a parete/soffitto (solo 1 veletta inclusa)
- Sliding doors set, wall/ceiling installation (only 1 cover included)
- Schiebetürset 2-flügelig, Wand-Deckenmontage (nur 1 Abdeckung enthalten)

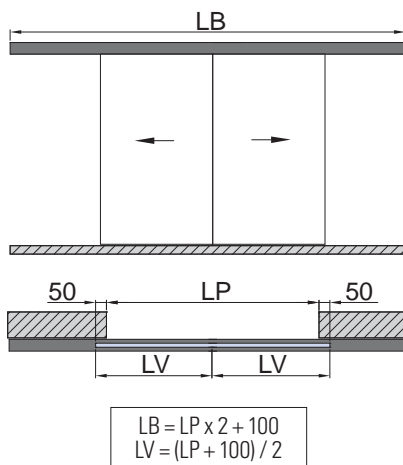
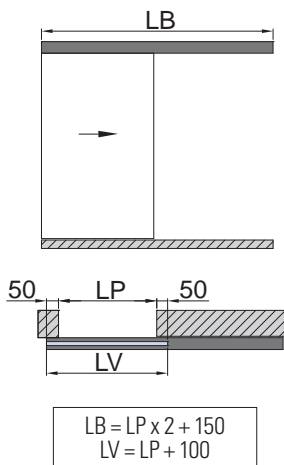

xme697

Componenti / Components / Einzelteile	Fin.	V-1000 SET 1	V-1010 SET 1	V-1020 SET 1	V-1000 SET 2	V-1010 SET 2	V-1020 SET 2
<b>V-1000</b> L=2000 L=3000 L=4000 L=6000	AN	1	1	1	1	1	1
<b>V-1001</b> L=2000 L=3000 L=4000 L=6000	AN / NV	1	1	1	1	1	1
<b>V-1002</b> senza / without Soft-close	-	1	-	-	2	-	-
<b>V-1012</b> con / with Soft-close 80 Kg	-	-	1	-	-	2	-
<b>V-1022</b> con / with Soft-close 70 Kg	-	-	-	1	-	-	2
<b>V-1008</b>	AN / NV	1	1	1	1	1	1
<b>V-012</b>	AN / NO	1	1	1	2	2	2

# EASY (OPTIONAL SOFT-CLOSE)



**V-1003 / V-1013 / V-1023**



**100 Kg**



8-10



12-12,7-13,5  
con/with/mit V-1817



550 min



SIMPLE

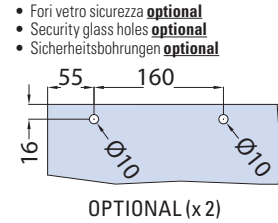
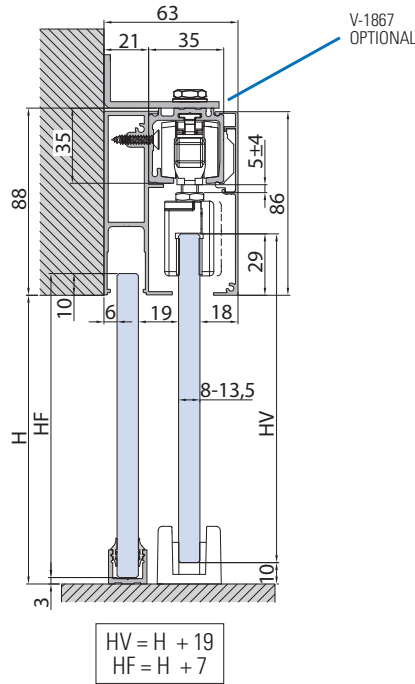
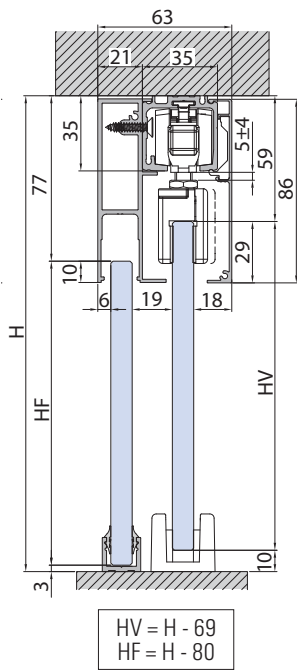
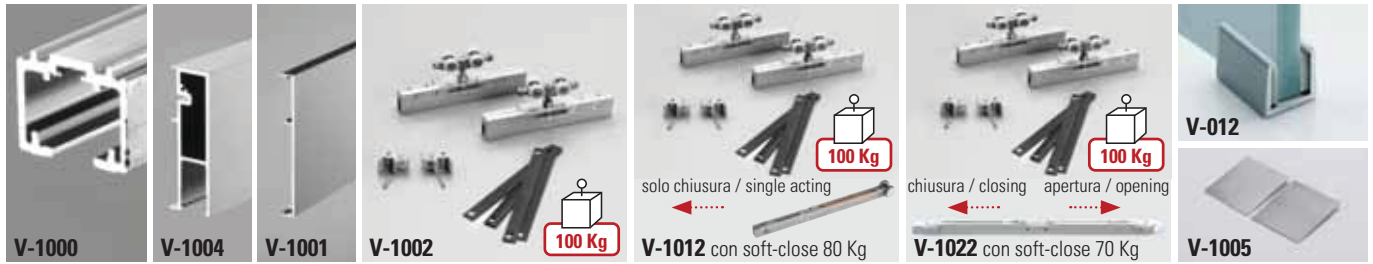

**COMPONENTI / COMPONENTS / EINZELTEILE**

- Fori vetro sicurezza **optional**
- Security glass holes **optional**
- Sicherheitsbohrungen **optional**

**V-1006-D70 SOFT-CLOSE**

Soft-close  
 chiusura / apertura double acting  
 dapplet Wirkende

Fori optional  
 Optional holes  
 Bohrungen optional

**V-1006-80 SOFT-CLOSE**

Soft-close  
 solo chiusura single acting  
 einzeln Wirkende

Fori optional  
 Optional holes  
 Bohrungen optional

**V-1006-D100 SOFT-CLOSE**

Soft-close  
 chiusura / apertura double acting  
 dapplet Wirkende

Fori optional  
 Optional holes  
 Bohrungen optional

**V-1003 / V-1013 / V-1023 SET 1**

- Set per 1 anta scorrevole e vetro fisso, fissaggio a soffitto o a parete
- Sliding door set with fixed panel, ceiling or wall installation
- Schiebetürset 1-flügelig mit Seitenteil, Wand-Deckenmontage

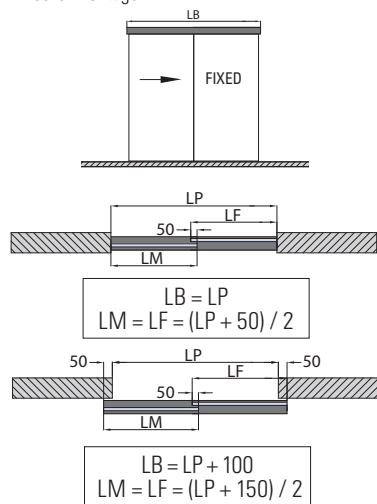
**V-1003 / V-1013 / V-1023 SET 2**

- Set per 2 ante scorrevoli e vetri fissi, fissaggio a parete/soffitto
- Sliding doors set with fixed panels, wall/ceiling installation
- Schiebetürset 2-flügelig mit Seitenteil, Wand-Deckenmontage

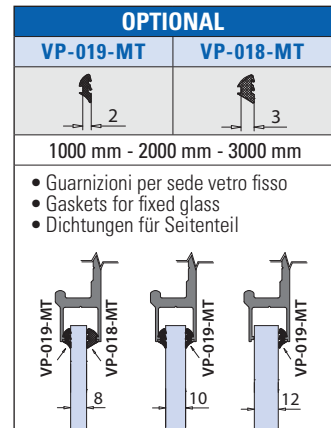
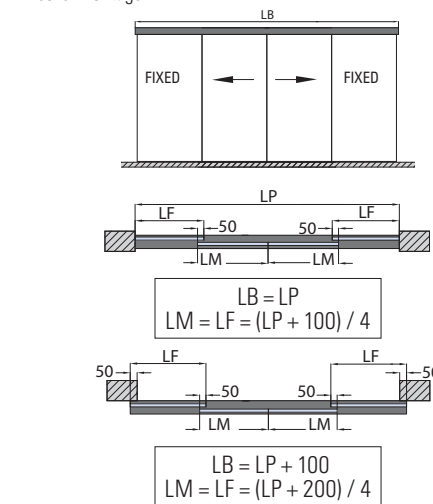

- Guarnizioni per sede vetro fisso
- Gaskets for fixed glass
- Dichtungen für Seitenteil

Componenti / Components / Einzelteile	Fin.	V-1003 SET 1	V-1013 SET 1	V-1023 SET 1	V-1003 SET 2	V-1013 SET 2	V-1023 SET 2
<b>V-1000</b> L=2000 L=3000 L=4000 L=6000	AN	1	1	1	1	1	1
<b>V-1004</b> L=2000 L=3000 L=4000 L=6000	AN / NV	1	1	1	1	1	1
<b>V-1001</b> L=2000 L=3000 L=4000 L=6000	AN / NV	1	1	1	1	1	1
<b>V-1002</b> senza / without Soft-close	-	1	-	-	2	-	-
<b>V-1012</b> con / with Soft-close 80 Kg	-	-	1	-	-	2	-
<b>V-1022</b> con / with Soft-close 70 Kg	-	-	-	1	-	-	2
<b>V-1867</b> Staffa (OPTIONAL)	-	1x400 mm	1x400 mm	1x400 mm	1x400 mm	1x400 mm	1x400 mm
<b>V-1005</b> (OPTIONAL)	AN / NV	1	1	1	1	1	1
<b>V-012</b>	AN / NO	1	1	1	2	2	2

xme697

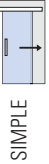

# V-1000 / V-1010 / V-1020 / V-1003 / V-1013 / V-1023 (OPTIONAL SOFT-CLOSE)

## COMPONENTI / COMPONENTS / EINZELTEILE



SIMPLE

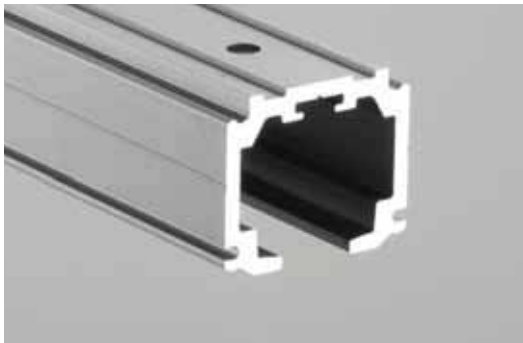

### V-1000

- Binario Scorrevole EASY
- Track profile EASY
- Laufschiennenprofil EASY

AN

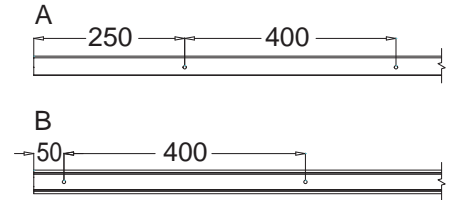
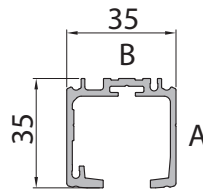

xme697a



### V-1001

- Veletta per binari EASY
- Cover profile for track profiles BEASY
- Profilabdeckung für Laufschiennenprofile EASY

AN - NV

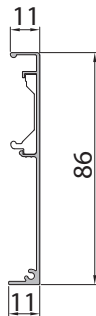

xme697a



### V-1004

- Profilo per vetro fisso EASY
- Side panel profile EASY
- Seitenteilprofil EASY

AN - NV

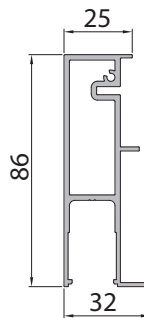

xme697a

OPTIONAL	
VP-019-MT	VP-018-MT
1000 mm - 2000 mm - 3000 mm	
<ul style="list-style-type: none"> <li>• Guarnizioni per sede vetro fisso</li> <li>• Gaskets for fixed glass</li> <li>• Dichtungen für Seitenteil</li> </ul>	



### V-1816

### V-090

### V-1218

100 Kg

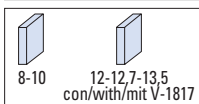

### V-1002

- Set accessori per 1 anta scorrevole composto da 2 carrelli, morsetti per vetro 8-10 mm. 2 stoppers
- Accessories set for 1 sliding panel consisting of N°2 trolley hangers with clamp carriage for 8/10 mm glass, N°2 endstops
- Zubehör für 1 Schiebetür bestehend aus: N°2 Klemm - Laufwagen für 8/10 mm Glas. N°2 Stopper

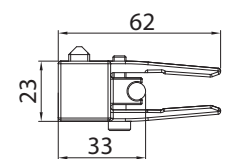
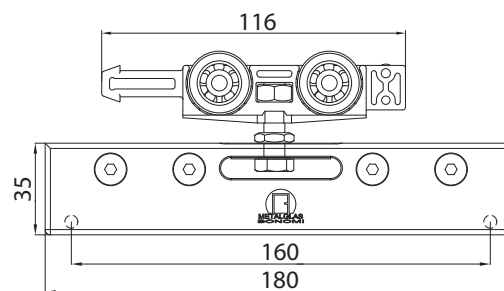

xme697a



### V-1012

- Set accessori per 1 anta scorrevole composto da carrelli, pinze portata 100 Kg con regolazione frontale e stoppers - Incluso Soft-close portata 80 Kg solo in chiusura
- Set for 1 sliding panel consisting of trolley hangers with clamps front adjustment, load capacity 100 Kg and stoppers - Soft-close 80 Kg single acting included
- Zubehör für 1 Schiebetür bestehend aus: Klemm-Laufwagen Tragkraft 100 Kg vorne Einstellung und Stoppers - Inkl. Soft-close 80 Kg einzeln Wirkende

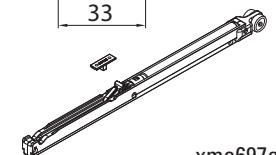
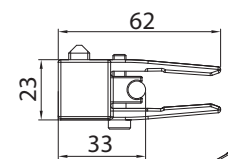
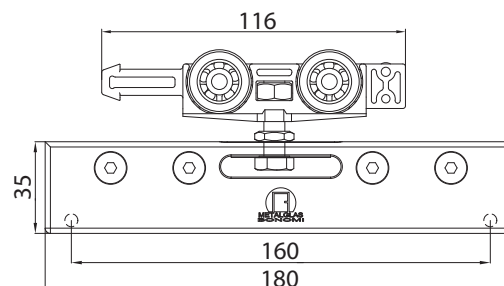

xme697a

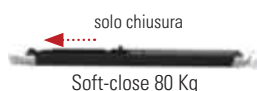

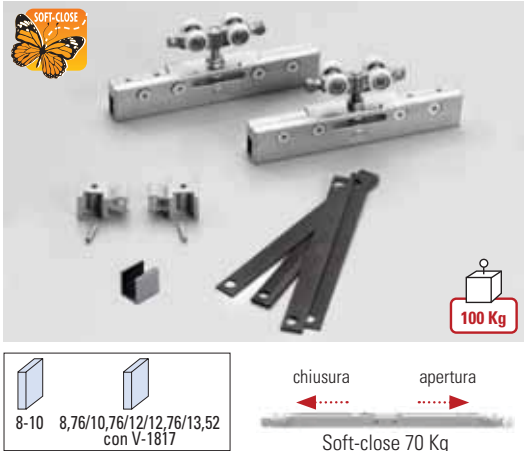

### V-1022

- Set accessori per 1 anta scorrevole composto da carrelli, pinze portata 100 Kg con regolazione frontale e stoppers - Incluso Soft-close doppia chiusura, portata 70 Kg
- Set for 1 sliding panel consisting of trolley hangers with clamps front adjustment, load capacity 100 Kg and stoppers - Soft-close 70 Kg double acting included
- Zubehör für 1 Schiebetür bestehend aus: Klemm-Laufwagen Tragkraft 100 Kg vorne Einstellung und Stoppers - Inkl. Soft-close doppelt Wirkende 70 Kg

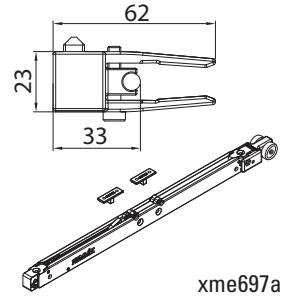
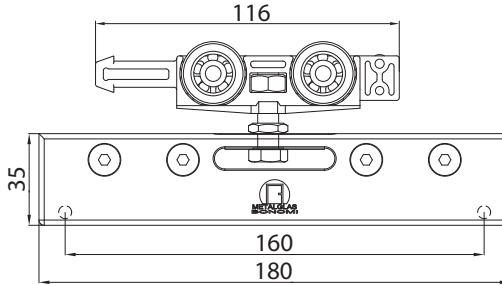

### V-1817

- Kit spessori per vetro 12-12,7-13,5 - per 2 pinze V-090 e V-090-T
- Kit spacers for glass thickness 12 - 12,7 - 13,5 for 2 clamps V-090 and V-090-T
- Kit Distanzscheiben für Glasdicke 12 - 12,7 - 13,5 für 2 Klemm-Laufwagen V-090 und V-090-T

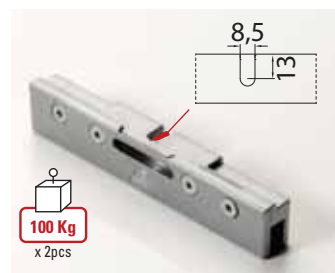
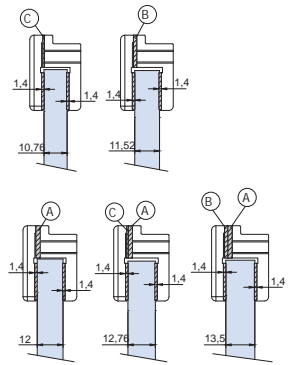
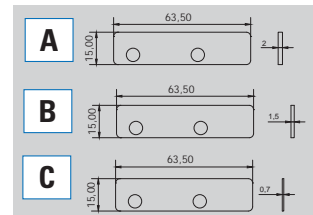

### V-090

- Pinza
- Clamp
- Klemmschuh

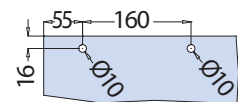

- Fori optional
- Holes optional
- Bohrungen Optional

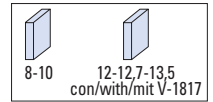
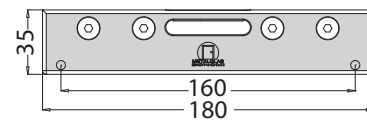

xme431c / xme425a



### V-012

- Guida a pavimento per scorrevole con feltrini per vetro 8 e 10 mm
  - Floor guide with felt strips for glass sliding door a 8 and 10mm
  - Bodenführung mit Filzgleiter für Glas 8 und 10 mm
- AN - NO

- Altri modelli disponibili a pag. 7
- Other models available on page.7
- Weitere Modelle auf Seite v

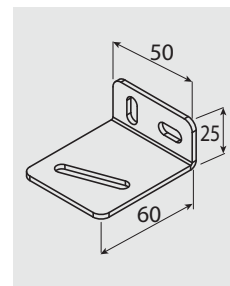
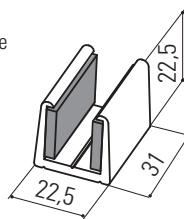

### V-1867

- Staffa per fissaggio a parete per sistema V-1003 (circa 1 pezzo ogni 400 mm)
- Angled profile for wall installation for system V-1003 (about 1 piece every 400 mm)
- Winkelverbinder für Wandmontage System V-1003 (1 Stück je ca 400 mm)

**V-1006-D70** - 70 Kg ←→

**V-1006-80** - 80 Kg ←

**V-1006-D100** - 100 Kg ←→

- Optional stopper Soft-close per sistemi V-1000 / V-1003
- Optional stopper with Soft-close mechanism for systems V-1000 / V-1003
- Optional Stopper mit Soft-close für Systeme V-1000 / V-1003

**V-1006-D70**

**V-1006-D100**

**V-1006-80**

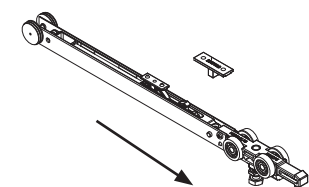
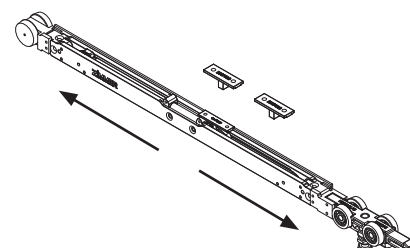
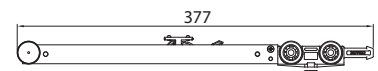
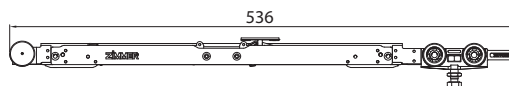
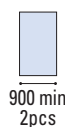
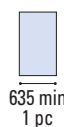
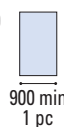
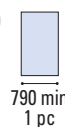

xme697a



SIMPLE

**V-1008**

- Paio tappi finali per binario V-1000
  - Pair endcaps for track profile V-1000
  - Paar Endkappe für Laufschienenprofil V-1000
- AN - NV

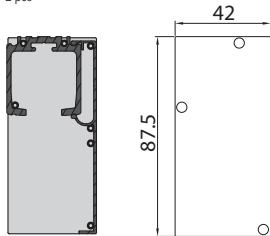

xme697a

**V-1009**

- Paio tappi finali per binario V-1000
  - Pair endcaps for track profile V-1000
  - Paar Endkappe für Laufschienenprofil V-1000
- AN - NV

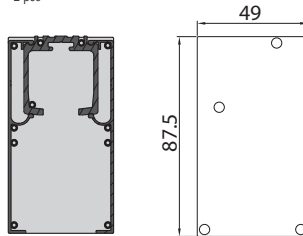

xme697a

**V-1005**

- Paio tappi finali per sistema V-1003
  - Pair endcaps for system V-1003
  - Paar Endkappe für System V-1003
- AN - NV

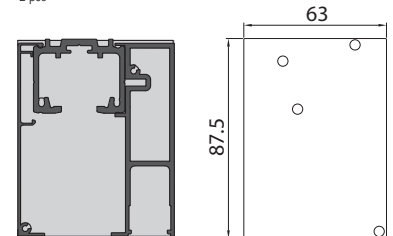

xme697a

**V-1216**

- Carrello
- Roller
- Rollenwagen

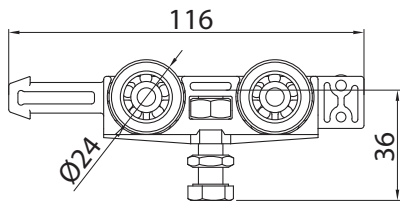

xme697a

**V-1218**

- Stoppers Brixia 80 kg

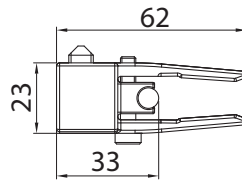

xme697a

**V-1217**

- Paio stoppers anti-shock Brixia
- Set stoppers anti-shock Brixia
- Set stoppers anti-shock Brixia

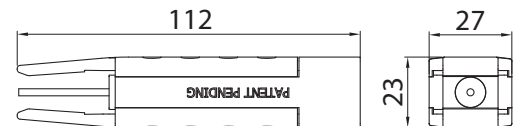

xme697a